



APPLICATION FOR BUILDING PERMIT

To: Zoning Officer
City Hall
201 S. Michigan Ave. | PO Box 298
Marshall, IL 62441
(217)826-8087

Building Permit Number: _____
Date Issued: _____
FOR CITY USE ONLY

Date Submitted: _____

Type of improvement:

- New Home or Primary Structure Addition Repair / Alteration
- Accessory Building (Detached Garage, Carport, Shed etc...) Fence
- Outdoor Furnace (Article I, Sec 8-1 to 8-7)

INSTRUCTIONS TO APPLICANT. All information required by this application must be completed and submitted. Any application that is incomplete will be rejected. Applicants are encouraged to visit the Zoning Officer at the Zoning Officer's Office for any assistance needed in completing this form.

1. Applicant's Name: _____
Address: _____
Phone Number: _____
2. Name of Owner(s) of Real Estate (If different than the Applicant's): _____

3. Common address of building site (lot number and street or road name): _____

4. Name of Contractor (if applicable): _____
Address: _____ Phone #: _____
5. Name of Roofing Contractor (if applicable): _____
IL State Roofing License Number: _____
Address: _____ Phone #: _____
6. Name of Roll Off Contractor (if applicable): _____
Address: _____ Phone #: _____
7. **Date of proposed construction:** _____

Other (describe) _____

8. Zoning for proposed site (check one)
_____ Single Family Residential
_____ Two Family Residential
_____ Multiple Family Residential*
_____ Business or Industrial*

*Site Plan requirements applicable to all multi-family residential and non-residential uses.

9. Legal description of property as indicated on deed (Lot, Block, and Subdivision):

10. Permanent Parcel Number: _____ - _____ - _____ - _____ - _____

11. Type of proposed use (check one)
- _____ Primary Residence Size: _____ x _____
- _____ Addition Size: _____ x _____
- _____ Residential Garage Attached Detached Size: _____ x _____
- _____ Residential Carport Attached Detached Size: _____ x _____
- _____ Residential Accessory Building Portable Size: _____ x _____
- _____ Non-Residential Building Attached Detached Size: _____ x _____
- _____ Fence Linear Feet Height Type
- _____ Outdoor Furnace Stack Height

12. Dimensions
- _____ Number of Stories
- _____ Total square feet of floor area (all floors, based on exterior dimensions)
- _____ Total land area, square feet

13. Off Street Parking (If Applicable)
- _____ Number of off street parking places

14. **Estimated Cost of Project:** _____

15. Attach a copy of a sketch or plat (drawn to approximate scale) showing the following:
(Please use graph grid paper):

- a) Dimensions of lot;
- b) Dimensions and use of all buildings currently on lot;
- c) Distance of each building from lot lines;
- d) Distance of principle buildings from principal buildings on adjacent lot(s);
- e) Distance between principle buildings and accessory buildings;
- f) Location (with dimensions of driveways and off-street parking spaces);
- g) Location of all easements;
- h) Location and dimensions of proposed project for which this application is for
(Please identify as proposed project)

Owner/Contractor is responsible for FULLY COMPLETING THE BUILDING PERMIT APPLICATION AND DRAWINGS; Stakeouts; J.U.L.I.E. Locate Requests; Erosion Control; Dirt on Roadway; Damage to Roadway; Curbs/Gutters, Illinois licensed roofing contractor.

All proposed construction must be staked out prior to permit approval. All stakeouts must have the building corners staked and lot lines stringed.

Application is hereby made for a building permit as required under the City of Marshall Municipal Code. In making this application, the applicant represents all of the above statements and any attached maps and drawings to be a true description of the proposed lot and project. The applicant agrees that the permit applied for, if granted, is issued on the representations made herein and that any permit issued may be revoked without notice on any breach of representation.

It is understood that any permit issued on this application will not grant the right or privilege to erect any structure or to use any premises described for any purpose or in any manner prohibited by the City of Marshall Municipal Code or by any other ordinances, codes or regulations of the City.

It is understood that no land shall be occupied or used and no building hereafter erected, altered or extended shall be used or changed in use until the Address is Posted; Final Grading is Done; and a Certificate of Occupancy issued by the Zoning Enforcing Officer (Building Inspector).

The undersigned Applicant (s) hereby affirms under penalty of perjury that the information provided in this application is true and correct.

Applicant: _____ Applicant: _____
Date Date Date

BUILDING PERMIT SITE DRAWING

Sketch or Drawing Instructions:

Show on the map: 1) Dimensions of lot, 2) Dimensions and Use of all buildings currently on lot, 3) Distance of each building from lot lines, 4) Distance of principle buildings from principal buildings on adjacent lot(s), 5) Distance from principle buildings and accessory buildings, 6) Location (with dimensions) of driveways and off-street parking spaces, 7) Location (with dimensions) of all easements, 8) Location and dimensions of proposed project for which this application is for (Please identify as proposed project).

Additionally map must contain: 1) North Arrow showing direction of North, 2) Label all streets, 3) Scale of drawing.

SETBACKS

Front Yard _____ Ft.
 Side Yard _____ Ft.
 Side Yard _____ Ft.
 Rear Yard _____ Ft.

BUILDING LOT COVERAGE

Primary Building _____ S.F.
 Accessory Building _____ S.F.
 Total Buildings on Lot _____ S.F.
 Lot Area _____ S.F.
 % Lot Coverage _____ S.F.

ZONING CLASSIFICATION

Proposed Lot _____
 Adjacent to North _____
 Adjacent to East _____
 Adjacent to South _____
 Adjacent to West _____

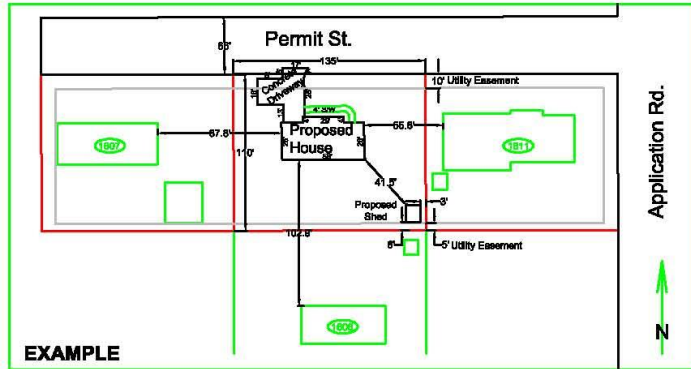

Scale of Drawing: 1 Block = _____ Feet

