

DARBY TP.  
UNION COUNTY  
1890.



37  
+ 8  
x 4  
x 3  
x 5  
x 2

# APPRAISER'S ACCOUNT.

TREASURY OF UNION COUNTY.

To Albert Adams Land Appraiser of Darby Township, Dr.

THE DATE OF EACH DAY	
Employed in making said Appraisal, was as follows:	
24 day of April	27 day of May
25 day of April	28 day of May
26 day of April	29 day of May
29 day of April	30 day of May
30 day of April	1 day of May
1 day of May	2 day of May
2 day of May	3 day of May
3 day of May	4 day of May
6 day of May	5 day of May
7 day of May	6 day of May
8 day of May	7 day of May
9 day of May	8 day of May
10 day of May	9 day of May
12 day of May	10 day of May
15 day of May	11 day of May
20 day of May	12 day of May
21 day of May	13 day of May
22 day of May	14 day of May
23 day of May	15 day of May
26 day of May	16 day of May
For assistance 2 days	17 day of May
	18 day of May
	19 day of May
	20 day of May
	21 day of May
	22 day of May
	23 day of May
	24 day of May
	25 day of May
	26 day of May
	27 day of May
	28 day of May
	29 day of May
	30 day of May
	31 day of May
	1 day of June
	2 day of June
	3 day of June
	4 day of June
	5 day of June
	6 day of June
	7 day of June
	8 day of June
	9 day of June
	10 day of June
	11 day of June
	12 day of June
	13 day of June
	14 day of June
	15 day of June
	16 day of June
	17 day of June
	18 day of June
	19 day of June
	20 day of June
	21 day of June
	22 day of June
	23 day of June
	24 day of June
	25 day of June
	26 day of June
	27 day of June
	28 day of June
	29 day of June
	30 day of June
	1 day of July
	2 day of July
	3 day of July
	4 day of July
	5 day of July
	6 day of July
	7 day of July
	8 day of July
	9 day of July
	10 day of July
	11 day of July
	12 day of July
	13 day of July
	14 day of July
	15 day of July
	16 day of July
	17 day of July
	18 day of July
	19 day of July
	20 day of July
	21 day of July
	22 day of July
	23 day of July
	24 day of July
	25 day of July
	26 day of July
	27 day of July
	28 day of July
	29 day of July
	30 day of July
	31 day of July
	1 day of August
	2 day of August
	3 day of August
	4 day of August
	5 day of August
	6 day of August
	7 day of August
	8 day of August
	9 day of August
	10 day of August
	11 day of August
	12 day of August
	13 day of August
	14 day of August
	15 day of August
	16 day of August
	17 day of August
	18 day of August
	19 day of August
	20 day of August
	21 day of August
	22 day of August
	23 day of August
	24 day of August
	25 day of August
	26 day of August
	27 day of August
	28 day of August
	29 day of August
	30 day of August
	31 day of August
	1 day of September
	2 day of September
	3 day of September
	4 day of September
	5 day of September
	6 day of September
	7 day of September
	8 day of September
	9 day of September
	10 day of September
	11 day of September
	12 day of September
	13 day of September
	14 day of September
	15 day of September
	16 day of September
	17 day of September
	18 day of September
	19 day of September
	20 day of September
	21 day of September
	22 day of September
	23 day of September
	24 day of September
	25 day of September
	26 day of September
	27 day of September
	28 day of September
	29 day of September
	30 day of September
	1 day of October
	2 day of October
	3 day of October
	4 day of October
	5 day of October
	6 day of October
	7 day of October
	8 day of October
	9 day of October
	10 day of October
	11 day of October
	12 day of October
	13 day of October
	14 day of October
	15 day of October
	16 day of October
	17 day of October
	18 day of October
	19 day of October
	20 day of October
	21 day of October
	22 day of October
	23 day of October
	24 day of October
	25 day of October
	26 day of October
	27 day of October
	28 day of October
	29 day of October
	30 day of October
	31 day of October
	1 day of November
	2 day of November
	3 day of November
	4 day of November
	5 day of November
	6 day of November
	7 day of November
	8 day of November
	9 day of November
	10 day of November
	11 day of November
	12 day of November
	13 day of November
	14 day of November
	15 day of November
	16 day of November
	17 day of November
	18 day of November
	19 day of November
	20 day of November
	21 day of November
	22 day of November
	23 day of November
	24 day of November
	25 day of November
	26 day of November
	27 day of November
	28 day of November
	29 day of November
	30 day of November
	1 day of December
	2 day of December
	3 day of December
	4 day of December
	5 day of December
	6 day of December
	7 day of December
	8 day of December
	9 day of December
	10 day of December
	11 day of December
	12 day of December
	13 day of December
	14 day of December
	15 day of December
	16 day of December
	17 day of December
	18 day of December
	19 day of December
	20 day of December
	21 day of December
	22 day of December
	23 day of December
	24 day of December
	25 day of December
	26 day of December
	27 day of December
	28 day of December
	29 day of December
	30 day of December
	31 day of December

For services rendered in appraising the Real Estate of said Township, for the year 1890, occupying 40 days, between the 23 day of April and the 26 day of June at \$ 2 per day, \$ 80.00

And the said Albert Adams being duly sworn, solemnly declares that the number of days herein stated, were necessarily occupied in the appraisal of said Township, and that this account is in all respects just and true.

(Signed,) Albert Adams Appraiser.

Sworn to and subscribed before me, this 26 day of June 1890.

(Signed) Wm M Mack Auditor of said County.

Received, July 5 1890, of the Auditor of Union County, an order on the Treasurer of said County, for Eighty Dollars, 00 Cents,

in full of the above account.

\$ 80.00 (Signed,) Albert Adams Appraiser.

The Auditor will draw his warrant for Eighty dollars in favor of said Appraiser on the Treasurer of said Co

D. Henderson  
B. K. Rowlett  
Thos M. Brannon



## APPRAISER'S OATH.

The State of Ohio, Union County, ss.

I, Albert Adams Land Appraiser for  
Warby Township, in the County of Union, and State of Ohio, do solemnly  
swear that the return to which this is attached contains a correct description of each parcel of Real Property, within said  
district, as far as I have been able to ascertain the same, and that the value attached to each parcel in said return is,  
as I verily believe, the full value thereof. Estimated agreeably to the rules prescribed therefor in the act for levying taxes  
on all property of this State, according to its true value.

Signed, Albert Adams  
Appraiser of said Township.

Sworn and subscribed to before me, the undersigned authority, this

26<sup>th</sup> day of June A. D. 1890.

Signed, Wm M Peck  
Auditor of said County.



# OFFICIAL STATEMENT OF SURVEYS.

No. of Original Survey.	Original Quantity.	Original Proprietors.	Water Course.	Page.	No.
2671	1000	Richard Stephenson	Darby's creek	6.	7063
2675	1000	Lucas Sullivant	Darby's creek	2.	7218
2879	1000	Lucas Sullivant	Darby's creek	58 3	7245
2977	600	Samuel Robinson	Darby's creek	8.	7388
3162	640	Lucas Sullivant	Darby's creek	12.	7393
3272	100	Lucas Sullivant	Darby's creek	11.	7397
3311	200	Lucas Sullivant	Darby's creek	5	7399
3312	122	Lucas Sullivant	Darby's creek	5	7400
3312	151	Lucas Sullivant	Darby's creek	5	7751 +
3482	546 <sup>2</sup> / <sub>3</sub>	Richard Stephenson	Darby's creek	7.	7759
3483	450	Richard Stephenson	Darby's creek	2.	7916
3484	800	Lucas Sullivant	Darby's creek	8	816
3682	310 <sup>2</sup> / <sub>3</sub>	Robert Power & Lucas Sullivant	Darby's creek	8	850
3687	548 <sup>2</sup> / <sub>3</sub>	John Scott	Darby's creek	7.	858
3881	344 <sup>1</sup> / <sub>2</sub>	John Knight	Darby's creek	8.	878
4067	1120	Elizabeth Rickman	Mill creek	3	
4903	100	William Petty	Darby's creek	4.	
4982	100	Batyer King	Darby's creek	9.	
4998	350	Peter Manifold	Darby's creek	2	
5005	200	Richard Smyth	Darby's creek	7.	
5008	657	Hugh Woodson	Darby's creek	4.	1098
5009	265	Hugh Woodson	Darby's creek	2.	
5053	42	Peter Manifold	Darby's creek	2.	
5111	80	Lucas Sullivant	Darby's creek	11.	
5122	100	Minor Smith	Darby's creek	2.	1224
5124	400	James Galloway jr	Darby's creek	6.	
5137-7964+7218	654 <sup>1</sup> / <sub>2</sub>	James Galloway jr	Darby's creek	3.	
5139	1000	Richard b. Anderson	Darby's creek	4	
5141	100	William Steel	Mill creek	4.	
5142	200	John Arnold	Mill creek	4.	
5236	100	Lucas Sullivant	Darby's creek	11.	
5743	200	James Galloway jr	Darby's creek	9.	
6233	100	Tuttle Hudson	Treacles creek	9.	
6602	683	James Galloway jr	Darby's & Treacles Creeks	9.	
6973	100	James Galloway jr	Darby's creek	11	

WE

Cour

situat



# OFFICIAL STATEMENT OF SURVEYS.

Page.	No. of Original Survey.	Original Quantity.	Original Proprietors.	Water Course.	Page.
6.	7063	60	James Galloway jr	Darby's creek	12.
2	7218	59 2/4	Benjamin W. Ladd	Darby's creek	6.
5 & 3	7245	543	James Johnston & John Graham	Darby's creek	10 & 5
8.	7388	91	John Graham	Darby's creek	12.
	7393	313	John Graham	Darby's creek	10.
12.	7397	100	James Johnston	Darby's creek	9.
11.	7399	86 2/3	Joseph Chambers	Darby's creek	9.
3	7400	100	Joseph Chambers	Darby's creek	9.
5	7751 + 7774	447	Walter Dun	Darby's creek	12.
5	7759	90	Gross Scruggs	Darby's creek	12.
7.	7916	800	James Johnston & John Graham	Darby's creek	9.
2					
8	8167	100	Walter Dun	Darby's creek	11.
8	8508	80	Walter Dun	Darby's creek	11 & 12.
7.	8586 + 8698	441	Walter Dun & John Graham	Darby's creek	10.
8.	8783	350	Walter Dun	Darby's creek	11.
3	9003	80	Joseph & Benj. W. Ladd & Thomas Rowille	Mills creek	4.
4.	9005	13	same	Darby creek	2.
9.					
2					
	10793	200	David Chapman	Darby's creek	11
7.	10810	75	Walter Dun	Darby's creek	12.
4.	10987 + 12170	153	David Chapman	Darby's creek	10.
2	11012	120	Walter Dun	Darby's creek	11.
2	12075	55	Hugh Woodson	Darby's creek	9.
11.	12169	200	Samuel Smith	Darby's creek	9.
2	12240 + 12877	258	William Schooler & Walter Dun	Darby's creek	11.
6.	12269	130	Thomas Lucas	Darby's creek	11.
3	12269	12	Thomas Lucas	Darby's creek	11.
4	12270	250	Thomas Lucas	Darby's creek	10.
4.	12927	40	Joseph Spencer	Darby's creek	9.
4.	14437	40	Michael Sager	Darby's creek	11.
11.	15310	80	James Galloway	Darby's creek	3.
9.					
9.					
11.					

WE HEREBY CERTIFY, that the foregoing is a true Schedule of the Original Surveys, Quantities, Proprietors, and Water Courses, taken from the Official Records, in the offices of the Auditor and Surveyor of Union County, Ohio, in which are situate the Lands and Lots assessed for taxation in Darby Township, Union County, Ohio.







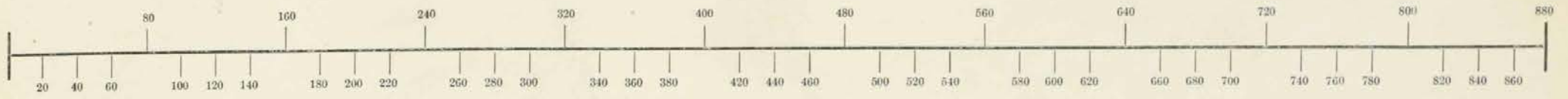















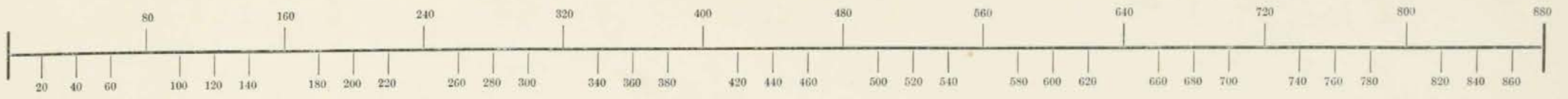

SCALE, 80 POLES TO AN INCH.

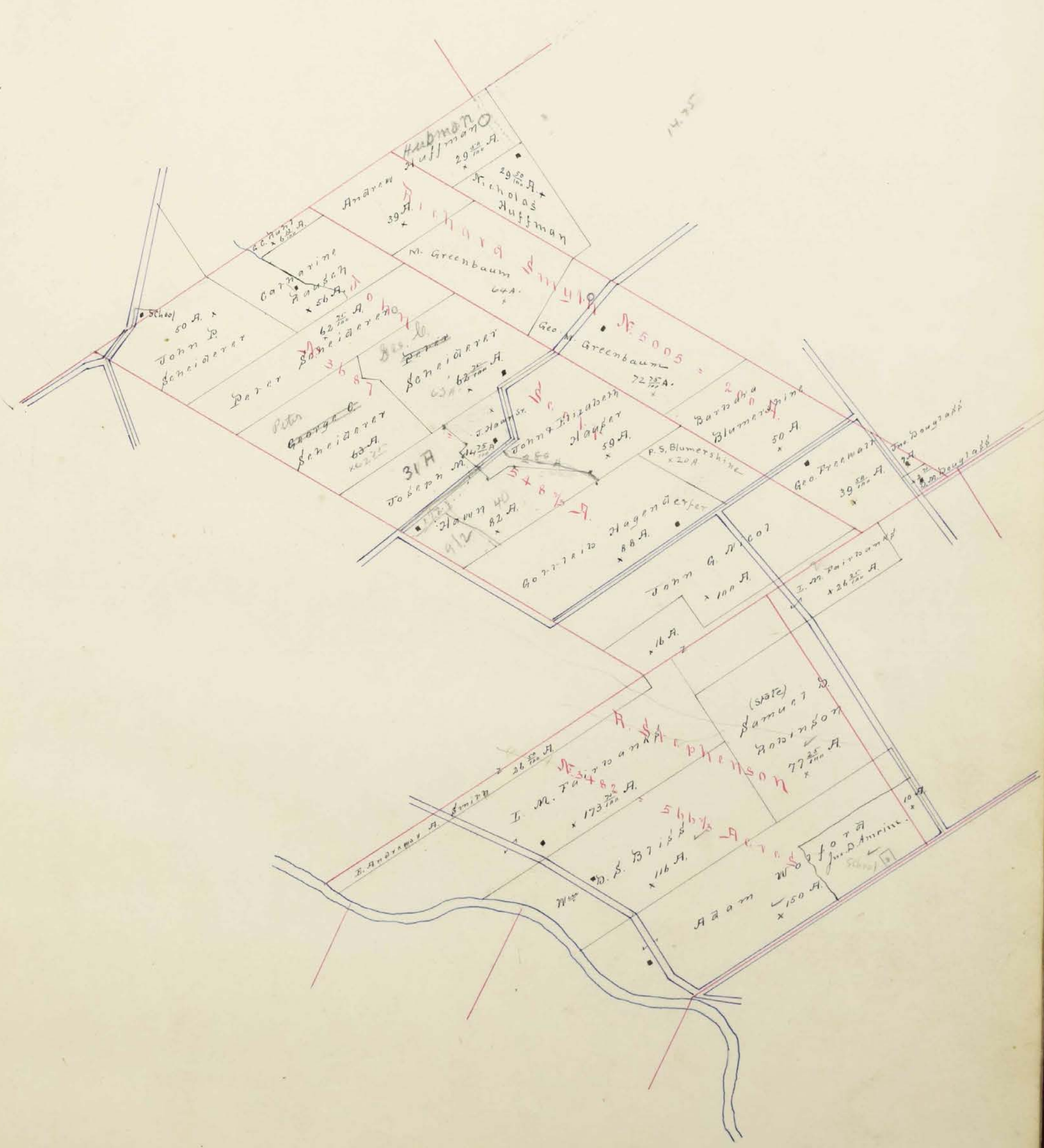











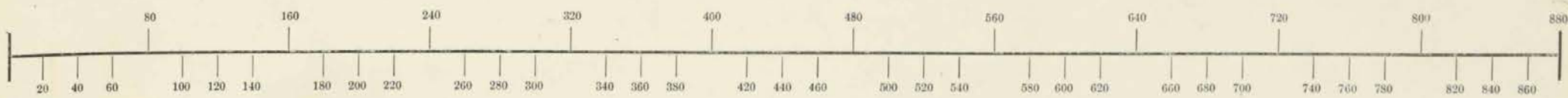

5 1/2



12 1/2



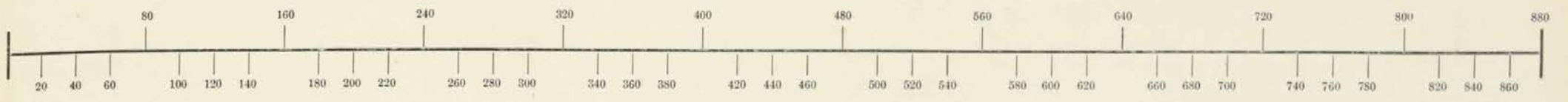







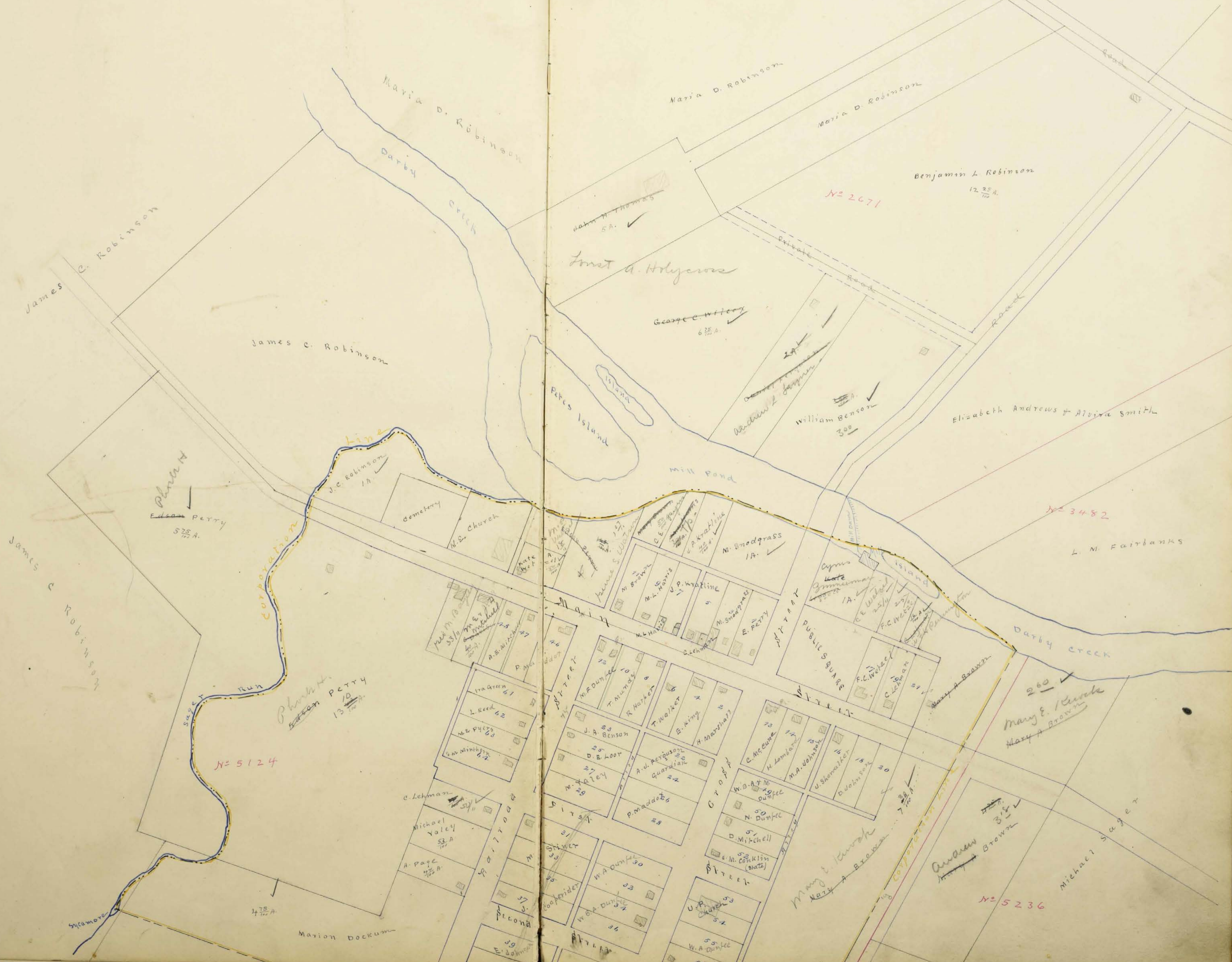
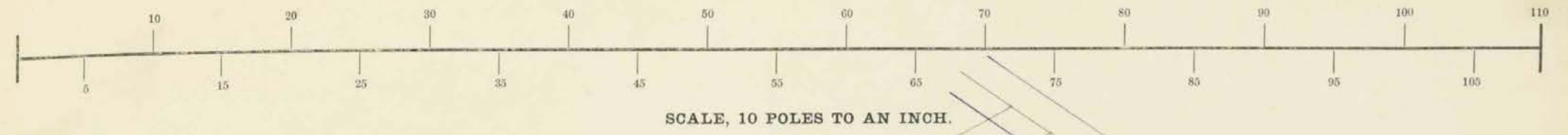















In Whose Name Assessed.	No. of Entry.	Original Quantity.	Original Proprietor.	Unincorporated Towns.	Feet Front.	No. of Acres of Land Classified.						Whole No. of Acres.	Value per Acre, excluding Buildings.	Total Value of Land, excluding Buildings.	Value of all Buildings.			Total Value of Land and Buildings.	Amount Added or Deducted by Co. Board of Equalization.		Total Value as Equalized by Co. Board.		Amount Added or Deducted by State Board of Equalization.		Total Value as Equalized by State Board.	REMARKS.
						Arable and Plow Land.		Meadow & Pasture Land.		Uncultivated and Wood Land.					Houses.	Mills.	Other Buildings.		Added Dollars.	Deducted Dollars.	Dollars.	Added Dollars.	Deducted Dollars.	Dollars.		
						Acres.	H.	Acres.	H.	Acres.	H.				Dollars.	Dollars.	Dollars.									
Dellinger Conrad 2 <sup>d</sup>	4913	100	W. Petty			12		37				49	20	980	250		1200	20		1220		176	1044	30	82	
same	5142	200	J. Arnold			11		8		6 25		35	35	20	400		500	10		510		73	437		83	
same	5142	200	same					24				24		20	480		480	10		490		71	419		84	
Dellinger Conrad 1 <sup>st</sup>	4067	1120	E. Richman			35		25		20		80	19	1520	150		1650	31		1681		243	1438	20	85	
same	4067	1120	same							20		20		18	360		360	8		368		53	315		86	
same	4067	1120	same					11				11		22	240		230	5		235		34	201	10	87	
Dellinger George	4067	1120	E. Richman			31		12		7 30		50	30	19	988	150		1090	20		1110		160	950	20	88
same	5008	657	H. Woodson			7		25		19 75		57	75	20	1040		1020	21		1041		150	891	20	89	
same	15320	80	J. Kallaway					5				5		20	100		100	2		102		14	88		90	
Dunbar Samuel W.	7245	543	Johnson & Abraham Unionville 577			1		54				1	54	34	50	150		200		201		29	172		91	
Doolfe John Jr	4067	1120	E. Richman			47		45		21 40		121	50	18	2190	400		2560	44		2604		377	2227	30	92
Douglas John	5139	1000	R. C. Anderson			26		27		41		44		21	1980	120	100	2160	40		2200		319	1881	40	93
same	5005	200	R. Smythe					7				7		23	160		150	4		154		22	132	10	94	
Douglas D. M.	5005	200	R. Smythe			2		75				2	75	35	90		80	2		82		11	71	10	95	
Debolt Thomas J.	12269	130	D. L. Lical			15		15				30		32 45	970	130		1090	20		1110		160	950	10	96
same	10793	200	D. Chapman			21		6				27		30 45	820		810	17		827		119	708	10	97	
Debolt Emily	10987+12170	153	D. Chapman					5				5		29	140	230		370	3		373		54	319		98
Debolt George W.	10987+12170	153	D. Chapman					11 75				11	75	30	350		350	7		357		51	306		99	
Dobson Marion	5124	400	J. Kallaway Unionville 105			1		1		2		4		40	160		160	4		164		23	141		100	
Emmett Williams	9003	80	Ladd & Merrill					19 25				19	25	15	290		280	6		286		41	245	10	2	
same	5142	200	J. Arnold			10		12 30				20	50	12	240		240	5		245		35	210	10	3	
Eirich Martin	3453	450	Stephenson and Sullivan			46		45		10 75		101	75	26	2650	140	100	2870	53		2923		423	2500	10	4
same	2879	1000	L. Sullivan			32		9		7 75		45	75	22	1070		1060	22		1082		156	926	10	5	
Pergerson Daniel	2671	1000	R. Stephenson Unionville 134			2						2		25	50	140		190	1		191		27	164		6
Pergerson A. J.	2671	1000	same			5		36		14 75		55	75	23	1280	120	100	1470	26		1496		216	1280	30	7
Shirbauck S. M.	3452	560 2/3	R. Stephenson			54		108		10 75		173	75	27	4680	200	200	5030	94		5124		742	4382	50	8
same	3687	548 2/3	J. Scott			8		8				16		24	380		380	8		388		56	332		9	
same	3682	310 2/3	Conr & Sullivan			26		35				26	25	23	600		600	12		612		88	524		10	
Dressalt George	5005	200	R. Smythe			20		17		2 40		39	50	22	870	220		1050	18		1068		153	915	40	11
Dunbar Andrew S.	7245	543	Johnson & Abraham Unionville			2		25				2	25	28	60		60	2		62		8	54		12	
Dunbar Mary C.	5115+5132+12170	688	W. Dew & Oltus					40		35 75		73	75	23	1680		1660	34		1694		245	1449	20	13	
same	5015+12170+12177	330	W. Dew & Oltus			36		49				85		24	2890	250	100	3200	58		3258		472	2786	40	14
same	same	330	same			20		31		10 50		61	50	32	1970		1940	40		1990		288	1702	20	15	
						472	79	644	50	228	45	1346	84		31400	2650	500	34500	648		35248		5089	30159	450	



In Whose Name Assessed.	No. of Entry.	Original Quantity.	Original Proprietor.	Unincorporated Towns.	Feet Front.	No. of Acres of Land Classified.				Whole No. of Acres.	Value per Acre excluding Buildings.	Total Value of Lands, excluding Buildings.	Value of all Buildings.			Total Value of Lands and Buildings.	Amount Added or Deducted by Co. Board of Equalization.		Total Value as Equalized by Co. Board.	Amount Added or Deducted by State Board of Equalization.		Total Value as Equalized by State Board.	REMARKS.		
						Arable and Plow Land.		Meadow & Pasture Land.					Uncultivated and Wood Land.		Houses.		Mills.	Other Buildings.		Added Dollars.	Deducted Dollars.			Added Dollars.	Deducted Dollars.
						Acres.	H.	Acres.	H.				Acres.	H.	Dollars.		Dollars.	Dollars.		Dollars.	Dollars.			Dollars.	Dollars.
Brenbaum George M	5005	200	R. Smythe			38	74	75			72 75	14	1020	100	1110	21	1031	163	968	10		16			
Brenbaum Michael	5005	200	R. Smythe			15	34	12			64	15	960		960	20	980	142	838			17			
Brenbaum Andrew	5139	1000	R. O. Anderson			45	53	3 58			100 85	20	2010		2010	41	2051	297	1754			18			
Brenbaum John	5139	1000	R. O. Anderson			5	25	20			57	22	1120		1100	23	1123	162	961	20		19			
same	4963	100	W. Petty			20	36	4 25			70 20	21	1480	200	1660	30	1690	245	1445	20		20			
Garr J. George	2675	1000	S. Sullivan			42 25					42 25	26	1100		1080	22	1102	159	943	20		21			
Bay Marshall R. & John	7751+7774	447	W. Deuss					25			25	24	680		700	12	712	103	609			22			
same	3162	640	S. Sullivan			60	63	23 25			146 25	94	4970	100	5010	100	5110	740	4370	60	(1060 3250)	23			
Gallaway J. B.	3652	310 2/3	Penry & Sullivan			40	22 50	22			54 50	19 50	1650		1600	33	1633	236	1397	50		24			
Holgers Samuel B.	7393	313	J. Graham			20	40	5			65	32	2080	900	3040	42	3082	446	2636	40		25			
same	8586+8698	441	Deuss & Graham			20	80	43			155	30	4650		4650	93	4743	687	4056			26			
same	7916	500	J. Johnson			25					28	31	870	100	950	18	968	140	828	20		27			
Harris George	5008	657	H. Woodson			40	89	30 50			159 50	18	2870	150	3050	58	3108	449	2659	70		28			
Harris John	5008	657	same			2					2	25	50	130	180	1	181	26	155			29			
Harris William	4998	350	P. Mansfield					36			36	15	470		440	11	551	79	472			30			
Harris Warren	3652	310 2/3	Penry & Sullivan			12	10 75				22 35	29	570	130	670	11	681	98	583	30		31			
same	3851	344 1/2	J. Knight			6	31	15 75			52 75	21	1100		1100	22	1122	162	960			32			
Harris Joseph Sr.	3657	548 2/3	J. Scott			13		1 75			14 75	14	220		210	5	215	31	184	10	(60 110)	33			
Harris Joseph M.	3657	548 2/3	J. Scott			39	35	14			52	21	1720	150	1950	35	1985	287	1698	20		34			
Hansen John & Elizabeth	3687	548 2/3	J. Scott			17	34	8			59	24	1410		1390	29	1419	205	1214	20	(60 1130)	35			
Hagendorf Gottlieb	3687	548 2/3	J. Scott			49	20	19			88	21	1850	200	1990	37	2027	292	1735	50		36			
Hamer Albert	5139	1000	R. O. Anderson				21 40				21 50	22	470		480	10	470	68	402	10		37			
Hamer Elizabeth	5139	1000	same				8				8	12	100		100	2	102	14	88			38			
Huffman Nicholas	5139	1000	R. O. Anderson				25	4 50			29 50	16	470		470	10	480	69	411			39			
Huffman Andrew	5139	1000	R. O. Anderson				20	9 50			29 50	17	500		500	10	510	73	437	same as Huffman			40		
same	5065	250	R. Smythe			25	14				29	18	700		700	14	714	103	711	same			41		
Hilbert Michael	5139	1000	R. O. Anderson			34	41	25 50			100 50	21	2110	270	2380	43	2423	358	2073			42			
Hunt Delmon	10793	200	D. Chapman			15	36	8 50			57 50	30	1790	600	2330	36	2366	343	2023	60		43			
Kantel Margaretta	5009	265	H. Woodson			53		35			88	19	1670	100	1750	34	1784	258	1526	60		44			
same	3483	450	Sullivan & Stephenson				21 50				21 50	25	570		540	11	551	79	472			45			
Kantel Peter S.	2879	1000	S. Sullivan			38	14				52	21	1090		1070	22	1092	158	834	20	Joseph K. C.	46			
same	2879	1000	same			8					8	16	130		130	3	133	19	114	same			47		
Kantel Leonard	5137+7964+7218	654 1/2	J. Gallaway			12	4	34			50	15	900		900	18	918	133	785			48			
Kuhlman Barbara C.	5137+7964+7218	654 1/2	J. Gallaway					25 50			25 50	17	430		420	9	429	62	367	10		49			
same	5209	265	H. Woodson			7		17 50			24 50	19	440		440	9	449	65	384	20		50			
Kliber Frederick	5137+7964+7218	654 1/2	J. Gallaway			17	5	21 75			73 75	25	1090		1070	22	1092	158	934	20		51			
						729 25	515 50	477 13			2021 85		35210	3130	45210	917	49127	7101	42096	630					
															48210										



In Whose Name Assessed.	No. of Entry.	Original Quantity.	Original Proprietor.	Unincorporated Towns.	Feet Front.	No. of Acres of Land Classified.						Whole No. of Acres.	Value per Acre excluding Buildings.	Total Value of Lands, excluding Buildings.	Value of all Buildings.			Total Value of Lands and Buildings.	Amount Added or Deducted by Co. Board of Equalization.		Total Value as Equalized by Co. Board.		Amount Added or Deducted by State Board of Equalization.		Total Value as Equalized by State Board.	REMARKS.	
						Arable and Plow Land.		Meadow & Pasture Land.		Uncultivated and Wood Land.					Houses.	Mills.	Other Buildings.		Added Dollars.	Deducted Dollars.	Dollars.	Added Dollars.	Deducted Dollars.	Dollars.			Dollars.
						Acres.	H.	Acres.	H.	Acres.	H.				Dollars.	Dollars.	Dollars.		Dollars.	Dollars.	Dollars.	Dollars.	Dollars.	Dollars.			Dollars.
<i>Kilbride John S.</i>	2879	1000	<i>L. Sullivant</i>			20	25	25				45	25	92	1450	200		140	1730	29		1759	255	1504	60	52	
<i>same</i>	2879	1000	<i>same</i>			38	14	12				64		19	1220				1200	25		1225	176	1049	20	53	
<i>Sullivan John A.</i>	4067	1120	<i>E. Richman</i>			73	48	39				160		24	3840				3800	77		3877	562	3315	40	54	
<i>Kilbury John</i>	3162	640	<i>L. Sullivant</i>			15	47	8	75			70	45	29	2050	100		100	2220	41		2261	327	1934	20	55	
<i>Kilbury William H.</i>	3162	640	<i>L. Sullivant</i>			55	35	60	25			150	25	31	4750	600		100	5780	95		5525	800	4725	20	56	
<i>Kilbury Solomon H.</i>	3162	640	<i>L. Sullivant</i>			41	67	84	40			140	40	32	6240	200		350	6720	125		6845	991	5854	70	57	
<i>same</i>	511 + 7753 + 12240 + 712577	688	<i>W. Dunn re.</i>			35	15	28	75			73	75	27	1990				1960	40		2000	290	1710	30	58	
<i>Kirck Mary A.</i>	2671	1000	<i>R. Stephenson</i>			24	38	20	15			52	25	19	1570			100	1670	32		1702	246	1456		59	
<i>Saline Frederick</i>	5124	400	<i>J. Gallows Jr.</i>			6	9	25				10	25	21	920			100	410	7		417	60	357	10	60	
<i>Keyse Albert</i>	3162	640	<i>L. Sullivant</i>			11	32	6	51			49	51	22	1100	100			1180	22		1202	174	1028	20	61	
<i>same</i>	5111	50	<i>same</i>			2	6	7	50			13	50	18	240				230	5		235	34	201	10	62	
<i>Kent Frank S.</i>	6233	100	<i>D. Hudson</i>			16						16		25	400				390	8		398	57	341	10	63	
<i>same</i>	5743	200	<i>J. Gallows</i>					4	50			4	50	25	110				110	3		113	16	97		64	
<i>Kent H. D. &amp; L. S.</i>	5743	200	<i>J. Gallows</i>			11	5					16		26	420				410	9		419	60	359	18	65	
<i>same</i>	6233	100	<i>D. Hudson</i>			8			7			15		27	400				400	8		408	59	349		66	
<i>Kent Miranda</i>	6233	100	<i>D. Hudson</i>						9			9		25	220				220	5		225	32	193		67	
<i>same</i>	6233	100	<i>same</i>					17				17		24	410				410	9		419	60	359		68	
<i>same</i>	5743	200	<i>J. Gallows</i>			16	6	1				28		23	430	100		100	710	11		721	90	631	20	69	
<i>Kirck John</i>	2671	1000	<i>R. Stephenson</i>			43	67	40				160		20	3200	120			3280	64		3344	484	2460	40	70	
<i>Schuman Christian</i>	5586 + 5698	1141	<i>Dunn &amp; Abraham</i>			62	17	21				100		26	2600				2600	52		2652	384	2268		71	
<i>Mr. Cullough John D.</i>	3484	800	<i>L. Sullivant</i>				10					10		12	120				120	3		123	17	106		72	
<i>same</i>	3484	800	<i>same</i>					6				6		14	80				80	2		82	11	71		73	
<i>same</i>	3162	640	<i>same</i>					7	75			7	75	12	90				90	2		92	13	79		74	
<i>Mr. Cullough James E.</i>	3484	800	<i>L. Sullivant</i>					20				20		15	800				800	6		806	44	262		75	
<i>Mr. Cloud Conrad</i>	8088	100	<i>W. Dunn</i>			4	64	35				4	64	35	160	250		100	570	4		514	74	440		76	
<i>Mr. Cloud Melissa J.</i>	7916	800	<i>Johnson &amp; Abraham</i>			57	49					100		29	2900				2800	58		2918	423	2495	40	77	
<i>same</i>	6602	683	<i>J. Gallows Jr.</i>					31	32			31	32	20	630				620	13		633	91	542	10	78	
<i>Mr. Donnell W. R.</i>	2879	1000	<i>L. Sullivant</i>			94	69	20	75			113	75	28	4740	150		100	5290	103		5393	781	4612	100	79	
<i>Mr. Kier Eli</i>	5139	1000	<i>R. C. Anderson</i>			7	13					20		14	280				280	6		286	41	245		80	
						630	64	494				1661		19	42760	1820			1190	4230	864		46094	6652	39442	540	



Assessment of Real Property in *Carby* Township,

DESCRIPTION OF PROPERTY.

No. of Acres of Land Classified.

Table with columns: In Whose Name Assessed, No. of Entry, Original Quantity, Original Proprietor, Unincorporated Towns, Feet Front, Acres, H., Acres, H., Acres, H.

963 68953 75 801 98

Union County, Ohio, for the Year 1890.

Table with columns: Whole No. of Acres, Value per Acre, Total Value of Lands, Value of all Buildings (Houses, Mills, Other Buildings), Total Value of Lands and Buildings, Amount Added or Deducted by Co. Board, Total Value as Equalized by Co. Board, Amount Added or Deducted by State Board, Total Value as Equalized by State Board, REMARKS, Page.

OK 3 1



7 Assessment of Real Property in *Darby* Township,

Union County, Ohio, for the Year 1890.

In Whose Name Assessed.	No. of Entry.	Original Quantity.	Original Proprietor.	Unincorporated Towns.	Feet Front.	No. of Acres of Land Classified.						Whole No. of Acres.	Value per Acre excluding Buildings.	Total Value of Lands, excluding Buildings.	Value of all Buildings.			Total Value of Lands and Buildings.	Amount Added or Deducted by Co. Board of Equalization.		Total Value as Equalized by Co. Board.	Amount Added or Deducted by State Board of Equalization.		Total Value as Equalized by State Board.	REMARKS.
						Arable and Plow Land.		Meadow & Pasture Land.		Uncultivat'd and Wood Land.					Houses.	Mills.	Other Buildings.		Added Dollars.	Deducted Dollars.		Added Dollars.	Deducted Dollars.		
						Acres.	H.	Acres.	H.	Acres.	H.				Dollars.	Dollars.	Dollars.								
Patch John	3851	344 1/2	J. Knight			1					1	20	20	150	170	1		171	24		147		20		
Patch Harmon	3851	344 1/2	J. Knight			5	18	17	50		36	50	17	620	620	13		633	91		542		2		
Summington W.D.H.	12240 + 12177	258	Schooler & Dunn			3					3		30	90	90	2		92	13		79		22		
same	14437	40	M. Sagar					5			5		28	140	140	3		143	20		123		23		
same	5111	80	L. Sullivan			2		4			6		27	160	160	4		164	23		141		24		
same	3272	100	L. Sullivan					48			48		25	1200	100	130	1380	24		1404	203	1201	50	25	
same	8783	350	W. Dunn			18	13	7			38		52	1220			1220	25		1245	179	1066		26	
Perry Edward	5124	400	J. Hallonay	Unionville				5	75		5	75	27	160			150	4		154	22	132	10	27	
Rudolph Conrad	5139	1000	R. O. Anderson			14	20	16			50		31	1050	300	100	1450	21		1471	213	1258		28	
Rudolph Michael	5139	1000	R. O. Anderson			35	38	24			102		20	2040			2020	41		2061	298	1763	20	29	
Robinson John Sr.	2977	600	J. Robinson			15	63	22			100		22	2200		120	2280	44		2324	336	1988	40	30	
same	2977	600	same			35	28	60	40		128	40	24	2400	100		3000	60		3060	443	2517	60	31	
Robinson W.H.	2977	600	J. Robinson			39	93	22			154		22	3390	200	100	3610	68		3678	533	3145	80	32	
Robinson James	2977	600	J. Robinson			40	75	40			123	40	28	3480	200	240	3800	70		3920	568	3352	80	33	
Robinson D.M.	5124	400	J. Hallonay			35	27	8			78		33	2370	250	200	2960	52		3012	436	2576	60	34	
same	3312	151	L. Sullivan			1		11			12		33	400			400	8		408	59	349		35	
same	7245	543	Johnson & Graham					20	20		40		30	1200			1200	24		1224	176	1048		36	
Robinson James C.	7245	543	Johnson & Graham	Unionville		6					6		30	180			180	4		184	26	158		38	
same	5124	400	J. Hallonay Jr.			57		20	13		126	13	27	3400	450	100	4110	68		4078	591	3487	40	39	
Robinson John Jr.	5124 + 7245	943	J. Hallonay Jr. et al.			26	44	10	75		80	75	32	3350	180	120	3800	52		3882	417	2465	50	40	
Robinson Benj. S.	2671	1000	R. Stephenson			12	25				12	25	25	310	100		400	7		407	59	348	10	41	
Robinson Sarah A.	2671	1000	R. Stephenson			45	10	23	91		75	92	27	2120	200		2280	43		2323	336	1987	40	42	
Robinson Maria	2671	1000	R. Stephenson			12	21	3	57		36	51	16	580	100		670	12		682	98	584	10	43	
Superintendent Leonard	2671	1000	R. Stephenson			24	20	6	50		50	50	19	950	100		1040	19		1059	153	906	10	44	
Superintendent Martin	9003	80	Ladd & Smith			12	19	18	75		49	75	20	990			990	20		970	140	830	40	45	
Superintendent Adlet	5018 + 9003	737	H. Warden et al.			5	75				5	75	22	230			220	5		225	32	193	10	46	
same	9003	80	Ladd & Smith			4	7	5			16		22	350			350	7		357	51	306		47	
same	4067	1120	C. Rickman			5		39	75		44	75	22	970			940	20		960	139	821	30	48	
Rausch George	15310	80	J. Hallonay			16	20	40	25		76	25	20	1420			1570	31		1541	223	1318	10	49	
same	4067	1120	C. Rickman					5	22	41	48	50	18	810	300	60	1150	17		1167	169	998	20	50	
same	5124 + 7245 + 7218	654 1/2	J. Hallonay Jr.			40	28	25			68	25	22	1500			1490	30		1520	220	1300	10	51	
same	same	654 1/2	same					9	75		9	75	16	160			160	4		164	23	141		52	
Rausch Phillip	5124 + 7245 + 7218	654 1/2	J. Hallonay Jr.			101	74	23			198		28	5540			5330	111		5641	817	4824	10	53	
same	4067	1120	C. Rickman			20	34	50			104		20	2080	350	100	2520	42		2562	371	2191	10	54	
same	7218	582 1/2	O.W. Ladd			67	7				74		30	2220			2190	45		2235	323	1912	20	55	
same	3879	1000	L. Sullivan			68	29	43			140		23	3220	520	120	3820	65		3885	562	3323	20	56	
same	5886 + 8098	441	Dunn & Graham			42	22				84		32	2690	140	150	2910	54		2964	429	2535	50	57	
Rausch John H.	5141	100	H. Steele			27	26	39			112		22	2470	600	130	3200	50		3250	471	2779		58	
same	5142	200	J. Arnold					30	50		30	50	25	760			760	16		776	112	664		59	
Robinson D. M.	7245	543	Johnson & Graham			31	18	10	75		57	25	28	1700	250	130	2050	34		2084	301	1783	30	37	
						900	100	943	65	591	71			2135	36		60220	4670	1790	64860	1220	67080	1700	57340	832



In Whose Name Assessed.	No. of Entry.	Original Quantity.	Original Proprietor.	Unincorporated Towns.	Feet Front.	No. of Acres of Land Classified.			Whole No. of Acres.	Value per Acre excluding Buildings.	Total Value of Lands, including Buildings.	Value of all Buildings.			Total Value of Lands and Buildings.	Amount Added or Deducted by Co. Board of Equalization.	Total Value as Equalized by Co. Board.	Amount Added or Deducted by State Board of Equalization.	Total Value as Equalized by State Board.	REMARKS.
						Arable and Plow Land.	Meadow & Pasture Land.	Uncultivated and Wood Land.				Houses.	Mills.	Other Buildings.						
Rausch John P.	4067	1120	C. Rickman			31	23	30	84	19	1600			1580	32	1612	233	1379	20	60
Rausch Geo. Adam	7400	100	J. Chamberl			81	11	8	100	25	2800			2800	58	2858	414	2444		61
same	12075	35	H. Wadson			2	88	24	26	88	750	300	140	1160	15	1175	169	1006	30	62
Rausch Casper	7393	313	J. Graham			47	9	4	60	32	1920	100	150	2150	39	2189	317	1872	20	63
same	4067	1120	C. Rickman			24	26	30	80	21	1650	250	140	2050	34	2084	301	1783	20	64
same	5132	100	M. Smith			30	20	3	53	24	1270			1270	26	1296	148	1108		65
same	9005	18	Sadd & Arnold				13		13	20	260			260	6	266	38	228		66
Rausch Christopher	5053	42	P. Mansfield			15	65	36	51	65	1030			1010	21	1031	149	882	20	67
same	4998	350	same					8 10	8	10	150			150	3	153	22	131		68
Rausch A. A. & W. L. & A. H.	5137+7984+7425	654 1/2	J. Gallomay Jr.			5	50	43	53	50	970			960	20	980	142	838	10	69
Rausch John Adam	11012	120	W. Dunn			6	7	80	13	80	400			390	8	398	57	341	10	70
Rausch Christopher	4067	1120	C. Rickman			7		4	11	20	220	150		370	5	375	54	321	Is Frederick Kleiber	71
Rausch Barnhart	7215	592 1/2	P. W. Sadd			6	35		6	35	170			170	4	174	25	149		72
Rausch Elizabeth	5743+6233	300	Gallomay & Hudson			25	6		31	26	800	110		890	16	906	131	775	10	73
Rausch Catharine	3687	548 2/3	J. Scott			33	23		56	25	1650			1650	33	1683	243	1440		74
Reid Sarah C.	3312	122	L. Sullinuck			16	35		16	35	290			280	6	286	41	245	10	75
Reid Elizabeth	3312	122	same			41		1 90	42	90	940	100		970	19	989	143	846	70	76
Reid Hester	8586+8698	441	Dunn & Graham			20	6		26	30	780			780	16	796	115	681		77
same	7393	313	J. Graham			15	13	25	33	63	1560	190	100	1840	32	1872	271	1601	10	78
same	7416	500	Johnston & Graham			3	13		3	13	90			90	2	92	13	79		79
Ruhl George C.	7215	592 1/2	P. W. Sadd			48	64	20 85	132	88	2920	430	200	3640	59	3699	536	3163	30	80
same	3687	548 2/3	J. Scott			6	13		6	13	160			160	4	164	23	141		81
Stromy Lewis	2579	1000	L. Sullinuck			47	46	20 50	117	50	2590	150	100	2820	52	2872	416	2456	20	82
Stromy Adam	5122	100	M. Smith			20	42	4	66	20	1320	200		1520	27	1547	224	1323		83
same	4998	350	P. Mansfield			20	5	16 60	41	50	710			700	15	715	103	612	10	84
same	5053	42	same					1 50	1	50	30			30	1	31	4	27		85
Sager Michael	14437	40	M. Sager			4	7	14	25	28	700			700	14	714	163	611		86
same	3272	100	L. Sullinuck				43		43	29	1250			1210	25	1235	178	1057	40	87
same	5236	100	same			10	76	10	96	28	2690	750	100	3480	54	3534	511	3023	50	88
same	5783	350	W. Dunn				23	30	53	27	1480			1480	30	1510	218	1292		89
Schneider Peter	3687	548 2/3	J. Scott			22	20	10 75	62	75	1370	100		1470	28	1498	217	1281		90
same	3687	548 2/3	same			12	39	11 20	62	75	1390	500		1920	27	1947	194	1153		91
same	7215	592 1/2	P. W. Sadd			25	24		49	24	1160	500	100	1640	24	1664	240	1424	20	92
same	5137+7984+7425	654 1/2	J. Gallomay Jr.			14	16	40	100	26	2600		120	2710	52	2762	400	2362	10	93
Schneider John P.	5137+7984+7425	654 1/2	J. Gallomay Jr.			23	17	8 75	48	75	1070			1050	22	1072	155	917	20	94
same	same	654 1/2	same					8	8	16	130			130	3	133	19	114		95
same	7215	592 1/2	P. W. Sadd			33	48	20 75	99	75	2190	150	130	2460	44	2504	362	2142	10	96
same	3687	548 2/3	J. Scott			13	13	24	50	20	1000			1000	20	1020	147	873		97
Schneider George C.	3687	548 2/3	J. Scott			20	24	19	63	23	1450	160		1570	29	1619	234	1385	20	98
same	4067	1120	C. Rickman			730	29	734	1918	66	45470	3750	1120	44930	925	50855	7350	43505	470	Not found



In Whose Name Assessed.	No. of Entry.	Original Quantity.	Original Proprietor.	Unincorporated Towns.	Feet Front.	No. of Acres of Land Classified.						Whole No. of Acres.		Value per Acre excluding Buildings.		Value of all Buildings.				Amount Added or Deducted by Co. Board of Equalization.		Total Value as Equalized by Co. Board.		Amount Added or Deducted by State Board of Equalization.		Total Value as Equalized by State Board.		REMARKS.	Page			
						Arable and Plow Land.		Meadow & Pasture Land.		Uncultivated and Wood Land.		Acres.	H.	Dolls.	Cts.	Dollars.	Cents.	Houses.	Mills.	Other Buildings.	Total Value of Lands and Buildings.	Added Dollars.	Deducted Dollars.	Dollars.	Added Dollars.	Deducted Dollars.	Dollars.			Added Dollars.	Deducted Dollars.	Dollars.
						Acres.	H.	Acres.	H.	Acres.	H.	Acres.	H.	Dollars.	Cents.	Dollars.	Cents.	Dollars.	Dollars.	Dollars.	Dollars.	Dollars.	Dollars.	Dollars.	Dollars.	Dollars.	Dollars.			Dollars.	Dollars.	Dollars.
Schneider Frederick	5005	657	H. Woodson			60	98	25	71			183	75	28	4220	350		4570	85		4655	674	3981			630	100					
Schneider John M.	4067	120	E. Rickman			55	58	62	25			175	35	25	4380	150	40	4500	88		4588	665	3923	70	200	20610	1					
Schneider John C.	5142	200	J. Arnold			22	49	35	25			106	75	21	2240	650		2890	45		2935	424	2511				2					
Schneider John S.	12109	200	J. Smith			49	10					57		27	1540	100	110	1790	32		1822	263	1559	10			3					
same	12075	55	H. Woodson					15	50			15	50	27	420			410	9		419	60	359	10			4					
Schneider Jacob & Wm	12078	55	H. Woodson					22	06			22	06	27	600			680	12		592	85	507	20			5					
same	7397	100	J. Johnson			22	5	5				38		29	1100			1090	32		1112	160	952	10			6					
same	7399	86 2/3	J. Chambliss			1	12	12				25		25	700			700	14		714	103	611				7					
same	7399	86 2/3	same			4	20	25				49		28	1370			1370	28		1398	203	1195				8					
same	4982	100	B. Shug.			30	22	3				60		26	1560	190	140	1870	32		1902	275	1627	20			9					
same	3312	122	L. Supt. v. ant			1	43					1	63	25	40			40	1		41	5	36				10					
same	12927	40	J. Spencer			22	3					25		30	750			750	15		765	110	655				11					
same	3312	122	L. Sullivant			6	50					6	50	25	160			160	4		164	23	141				12					
same	3312 + 7245	665	J. Johnson sr.			4	19					4	19	25	110			100	3		103	14	89	100			13					
Schneider Jacob	5018	657	H. Woodson			24	11	2	25			37	25	21	780	250		1030	16		1046	152	894				14					
same	5142	200	J. Arnold			3	56	15				74		22	1630			1630	33		1663	240	1423				15					
Smith Adeline D.	12270 + 10857 + 12170	403	Lucas + Chapman			29	85					29	85	32	950	100	130	1160	19		1179	171	1008	20			16					
same	8586 + 8698	441	Dunn + Graham			10	15					10	15	25	250			240	5		245	35	210	10			17					
Smith A. C.	12270	250	D. Lucas			10	14	10	25			34	25	32	1100	100	200	1390	22		1412	204	1208	10			18					
Smith James S.	12270	250	D. Lucas			21	40					70		32	2290	200	100	2560	46		2606	378	2228	30			19					
same	8586 + 8698	441	Dunn + Graham					17	85			17	85	30	540			430	11		541	78	463	10			20					
same	8586 + 8698	441	same			4	19					25		30	690			690	14		704	102	602				21					
same	7398	313	J. Graham					22				22		34	740			730	15		745	108	637	10			22					
same	4393 + 12270	563	Graham + Lucas					12	20	65		32	65	34	1110			1090	23		1113	160	953	20			23					
Smith John W.	7916	500	Johnson + Graham					207	25			232		28	6500	130		6560	130		6690	470	5720	70			24					
same	7916	500	same			18	19					47		30	1410			1380	29		1409	204	1205	50			25					
same	6602	683	J. Galloway			17	16	26	93			57	93	27	1540			1530	32		1582	229	1353	10			26					
Smith Sonina	7751 + 7774	447	W. Dunn			14	70					14	70	26	380	100		460	8		468	67	401	20			27					
same	3160	640	L. Sullivant			47	6	6	19			59	19	29	1720	140		1850	35		1865	269	1596	50			28					
Smith Elroy	7751 + 7774	447	W. Dunn			49	4	20	12			73	12	29	2120	100		2190	43		2233	323	1910	30			29					
Smith O. C.	7751 + 7774	447	W. Dunn			7	50					7	50	30	220			220	5		225	32	193				30					
same	3162	640	L. Sullivant					94	08			44	08	30	1340			1340	27		1367	197	1170				31					
same	10810	75	W. Dunn			75	50	33				75	50	33	2590	190	100	2840	52		2892	419	2473	40			32					
same	7388	91	J. Graham			23	30	40	50			93	30	30	2840	550	100	3430	57		3487	504	2983	60			33					
same	8508	80	W. Dunn			4	50					4	50	33	140			120	3		123	17	106	20			34					
Stevens George W.	8167	100	W. Dunn			5	42	15	75			65	75	31	80	2100	800	250	3120	42		3162	458	2704	30			35				
same	8088 + 12222 + 12577	330	W. Dunn sr.			37	90	50	50			197	50	71	4700			5690	114		5804	841	4963	10			36					
Snider Phillip	5139	1000	P. C. Anderson			36	47	30	25			111	25	17	890		100	940	18		958	138	820	50			37					
Sturhoff John A.	3483	450	Sturhoff + Sullivant					4				4		20	80			70	2		72	10	62	10			38					
same	507 + 1964 + 7215	654 2/3	J. Galloway			31	11	95				50		22	1760	120	180	2020	36		2056	298	1758	60			39					
same	2879	1000	L. Sullivant			14	90	75				44	75	23	1030			1000	21		1021	147	874	30			40					
same	3311	200	same					4				4	75	22	100			100	2		102	14	88				41					
Schwartzkopf John S.	4067	1120	E. Rickman			23	36	12	70			71	70	22	1580	160		1680	32		1712	247	1465	60			42					
same	5008	157	H. Woodson			13	5	25				15	25	22	400			380	8		388	56	332	20			43					
same	15310	80	J. Galloway					5				5		20	100			100	2		102	14	88									
						760	04	772	57	854	15	2417	60		63880	4330	1450	68990	1292		70182	10146	60036	820								







Assessment of Real Property in Unionville ~~Parby~~ Township,

Union County, Ohio, for the Year 1890.

In Whose Name Assessed.	No. of Entry.	Original Quantity.	Original Proprietor.	Feet Front.	No. of Acres of Land Classified.			Whole No. of Acres.	Value per Acre excluding Buildings.	Total Value of Lands, excluding Buildings.	Value of all Buildings.			Total Value of Lands and Buildings.	Amount Added or Deducted by Co. Board of Equalization.		Total Value as Equalized by Co. Board.	Amount Added or Deducted by State Board of Equalization.		Total Value as Equalized by State Board.	REMARKS.	Page	
					Arable and Plow Land.	Meadow & Pasture Land.	Uncultivated and Wood Land.				Houses.	Mills.	Other Buildings.		Added Dollars.	Deducted Dollars.		Added Dollars.	Deducted Dollars.				
					Acres.	H.	Acres.				H.	Acres.	H.		Acres.	H.		Dolls.	Cts.				Dollars.
Brown Andrew	5783	350	W. Durr					25	40	10			10	1		11		1		10		1	
Brown Mary A.	5724	400	J. Kallomay	Main Street 166				7	40	45	930	130	460	7		467		67		400		1	
Brown Indry	5724	400	same	Alley 82				50		20			20	1		21		3		18		2	
Comer Cath. H.	7245	543	Johnson + Graham	6th & P. R.R.				1		20			20	1		21		3		18		2	
Davis Cynthia	5724	400	J. Kallomay	Main Street 52				40		40	100		140	1		141		20		141		3	
Dochow Marion	5724	400	J. Kallomay	Railroad Street 395				4	75	200		100	300	4		304		44		260		3	
Dunfee Samuel W.	7245	543	J. Johnson re.					2		70	150		150			70		22		160		4	
Dunfee W. S. A.	7245	543	J. Johnson re.	Railroad Street 60				4	16	320			320	7		327		47		290		4	
Dochow Walter L.	5724	400	J. Kallomay																				
Dunn Andrew S.	7245	543	J. Johnson re.	6th & P. R.R. 160				5	19	170			170	4		174		25		149		5	
same	5724	400	J. Kallomay	Main Street 198				1		30			30	1		31		4		27		5	
Harris Mary S.	5724	400	J. Kallomay	Alley 66				30		10			10	1		11		1		10		6	
Kretelins J. P.	5724	400	J. Kallomay	Alley 78				40		20			20	1		21		3		18		6	
Lehman G.	5724	400	J. Kallomay					16		10			10	1		11		1		10		14	
Lehman C.	5724	400	J. Kallomay	Railroad Street 82 50				38		30	200		230	1		231		33		198		7	
Leggatte Kate	5724	400	J. Kallomay	Across Street				1		40	2000		2040	1		2041		295		1746		7	
Pager Stella	5724	400	J. Kallomay	Railroad Street 58				44		50	100		150	1		151		21		130		8	
Perry Edison	5724	400	J. Kallomay	Main Street 575				13	43	460	150	150	760	10		770		111		659		8	
same	5724	400	same	Main Street 157				125		130			130	3		133		19		114		9	
Robinson A. M.	7245	543	J. Johnson re.	Road 163				20		10			10	1		11		1		10		10	
same	5724	400	J. Kallomay	Third Street 37				85		20	1000		1020	1		1021		147		874		10	
Robinson James C.	5724	400	J. Kallomay	Main Street 191				1		30			30	1		31		4		27		11	
Snodgrass Melicia	5724	400	J. Kallomay	Across Street				1		40			40	1		41		5		36		11	
Witzel Francis C.	5724	400	J. Kallomay	Alley 145				48		70	100		110	1		111		16		95	3 Sheds 145 ft. and 145 ft. 124	124	
Witzel Kate A.	5724	400	J. Kallomay	Main Street 100				50		40	130		170	1		171		24		147		12	
Valery Michael	5724	400	J. Kallomay	Railroad Street 114				53		70			70	2		72		10		62		13	
W. C. S. L. & R.	7245	543	J. Johnson re.	6th & P. R.R.				65		90	740		830	1		831		37		224		13	
								57	72	2200	1150	3000	250	6600	57		6657		952		5705		



DESCRIPTION OF PROPERTY.

No. of Acres of Land Classified.  
Arable and Plow Land. Meadow & Pasture Land. Uncultivat'd and Wood Land.

In Whose Name Assessed.	No. of Entry.	Original Quantity.	Original Proprietor.	Unincorporated Towns.	Feet Front.	No. of Acres of Land Classified.														
						Arable and Plow Land.		Meadow & Pasture Land.		Uncultivat'd and Wood Land.										
<i>School houses</i>																				
No 1	65 X 100 ft =	24 160	A		Page 1	565	76	710	60	446	41									
" 2	95 X 196 ft =	20 180	A		" 2	624	13	713	91	394	50									
" 3		10 160	A		" 3	472	19	645	20	228	55									
" 4	457 X 136 ft	10 160	A		" 4	724	25	815	50	477	13									
" 5	170 X 156 ft	30 160	A		" 5	650	64	504		456	53									
" 6	80 X 80 ft	10 160	A		" 6	969	84	969	75	801	98									
" 7		10 160	A		" 7	900		943	65	591	71									
" 8		90 160	A		" 8	730	79	734	43	443	44									
" 9	80 X 100 ft	10 160	A		" 9	760	94	772	57	884	15									
" 10		20 160	A		" 10	604	45	592	60	287	10									
		210				2901	82	7492	25	5054	00									

Methoden Church school 100 X 150 ft 7 1/2 #20 4800

*Churches*  
 Holy Gospel M.E. Church 60 X 72 ft #20 4700.  
 Methoden Church 220 X 90 ft 20 #2000.  
 Mt Olive Christian 80 X 160 ft 10 800.  
 Unionville M.E. Church 90 X 66 ft 20 800.  
 Unionville U.P. Church 132 X 148 80 1000.  
 #4600

Value of all Buildings. Total Value of Lands and Buildings. Amount Added or Deducted by Co. Board of Equalization. Total Value as Equalized by Co. Board. Amount Added or Deducted by State Board of Equalization. Total Value as Equalized by State Board.

Whole No. of Acres.	Value per Acre excluding Buildings.	Total Value of Lands, including Buildings.	Value of all Buildings.			Total Value of Lands and Buildings.	Amount Added or Deducted by Co. Board of Equalization.	Total Value as Equalized by Co. Board.	Amount Added or Deducted by State Board of Equalization.	Total Value as Equalized by State Board.	REMARKS.
			Houses.	Mills.	Other Buildings.						
1775	16	113210	3240		940	45710	863		46873		610
1784	49	44080	14910		1160	49570	894		50464		380
1916	44	31800	2650		600	32400	648		35248		550
2021	88	95210	3130		300	98300	917		49127		630
1661	17	42760	1820		1170	43930	864		46094		540
2229	61	64010	3990		1230	68310	1295		69605		920
2435	36	60230	4670		1790	64860	1220		67080		830
1918	66	45770	3750		1180	46950	925		50855		470
2417	60	69880	4380		1450	68890	1292		70182		820
1364	05	92560	1360		380	93870	659		34529		430
19447	87	461740	93900		10620	499550	9577		520057		6280

*Coverage for road #13,7147  
 .. after deducting roads #23,3867  
 .. with buildings #25,680*



In Whose Name Assessed.	DESCRIPTION OF PROPERTY.								Value of Lots. Dollars.	Value of all Buildings.			Amount Added or Deducted by Co. Board of Equalization.		Total Value as Equalized by Co. Board.		Amount Added or Deducted by State Board of Equalization.		Total Value as Equalized by State Board.		REMARKS.
	No. of In-Lot.	No. of Out-Lot.	What Part.	Street.	Feet.	Street.	Feet.	Houses.		Mills.	Other Buildings.	Total Value of Lots and Buildings. Dollars.	Added Dollars.	Deducted Dollars.	Dollars.	Added Dollars.	Deducted Dollars.	Dollars.			
								Dollars.		Dollars.	Dollars.										
Brown Mary A.	20		All	Main	66		198	40			40	1		41	5		36			17	
same	21		All	Main	66		198	40			40	1		41	5		36			17	
Brown Mary	11		All	Main	66	Alley	198	60	150		210	5		215	31		184			18	
Brown Chandler	38		All	Cross	66	Second	222 75	40			40	1		41	5		36			18	
same	40		All	Cross	66		222 75	40			40	1		41	5		36			19	
same	42		All	Cross	66		222 75	40			40	1		41	5		36			19	
Brown Nancy J.	66		All	Railroad	57		198	30	100		130	3		133	19		114			20	
Brown Mary	69		All	Railroad	57		198	30			30	1		31	4		27			20	
same	70		All	Railroad	57	Fourth	198	30	270		300	6		306	44		262			21	
Brown John Ch.	71		All	Railroad	55	Fourth	198	30			90	1		31	4		27			21	
same	72		All	Railroad	55		198	20			20	1		21	3		18			22	
Barley Mary E.	74		All	Railroad	55		198	20	120		140	3		143	20		123			22	
same	83		All	Fourth	214	50	Alley	235			30	1		31	4		27			23	
Benson John A.	23		All	Railroad	66	Alley	198	50	150		200	4		204	27		175			23	
Cooperider John	35		All	Railroad	66		198	40			40	1		41	5		36			24	
same	37		All	Railroad	66	Second	198	40	100		140	3		143	20		123			24	
Cooperider Wm E.	73		All	Railroad	55		198	20	120		140	3		143	20		123			25	
Carmell Sarah J.	56		All	Cross	66	Second	198	30	100		130	3		133	19		114			25	
Dunfee W. B. A.	34		All	Cross	66		222 75	40	250		290	6		296	42		254			26	
same	36		All	Cross	66	Second	222 75	40			40	1		41	5		36			26	
Dunfee W. B. A. & W.	49		All	Cross	66	Alley	198	50			50	1		51	7		44	to corporation		27	
Dunfee Nancy	50		All	Cross	66		198	40			40	1		41	5		36			27	
Dunfee Mahala F.	10		W. Side	Main	6		198	10			10	1		11	1		10			28	
same	12		All	Main	66		198	60		200	260	6		266	38		228			28	
Dunfee Waldo A.	30		All	Cross	66	First	222 75	40			40	1		41	5		36			29	
same	32		All	Cross	66		222 75	40	100		140	3		143	20		123			29	
same	55		All	Cross	66		198	30			30	1		31	4		27			30	
Douss Thomas	57		All	Cross	66	Second	198	30			30	1		31	4		27	Should be Davis		30	
same	58		All	Cross	66		198	30	100		130	3		133	19		114			31	
Doctum Hattie V.	75		All	Railroad	55		198	20			20	1		21	3		18			31	
same	76		All	Railroad	182		169	20			20	1		21	3		18			32	
Davis Cynthia	48		W. Side	Main	14		198	10			10	1		11	1		10			32	
Ferguson A. J. (American)	22		All	Cross	66	Alley	222 75	50	100		150	3		153	22		131			33	
same	24		All	Cross	66		222 75	50			50	1		51	7		44			33	
Fenner A. L.	60		All	Cross	66	Third	198	30	200		230	5		235	34		201			34	
Green Ira	61		All	Railroad	66	Alley	198	50			50	1		51	7		44			34	
								1270		1860	200	3330	78		3408	474		2934			



In Whose Name Assessed.	DESCRIPTION OF PROPERTY.								Value of Lots. Dollars.	Value of all Buildings.			Total Value of Lots and Buildings. Dollars.	Amount Added or Deducted by Co. Board of Equalization.		Total Value as Equalized by Co. Board. Dollars.	Amount Added or Deducted by State Board of Equalization.		Total Value as Equalized by State Board. Dollars.	REMARKS.	Page		
	No. of In-Lot.	No. of Out-Lot.	What Part.	Street.	Feet.	Street.	Feet.	Dollars.		Houses.	Mills.	Other Buildings.		Added Dollars.	Deducted Dollars.		Dollars.	Added Dollars.				Deducted Dollars.	Dollars.
										Dollars.	Dollars.	Dollars.											
Harper Reno	8		All	Main	66	Alley	198	70				2		72			10	62		35			
Harris Mary S.	7		S.W. Corner	Main	20		40	10				1		11			1	10		35			
Same	9		All	Main	66		198	70	140			5		215			31	184		36			
Heistand Daniel	41		All	Railroad	66		198	40				1		41			5	36		36			
Same	43		All	Railroad	66		198	40				1		41			5	36		37			
Same	45		All	Railroad	66	Third	198	40	190			4		194			28	166		37			
Same	39		S. part	Railroad	13	25	198	10				1		11			1	10		59			
Johnson Mary S.	15		All	Main	66	Alley	198	60				2		62			8	54		38			
Johnson S. P.	18		All	Main	66		198	60				2		62			8	54		38			
Johnson Elenora	39		W. part	Railroad	52	75	198	30	200			5		235			34	201		39			
Kriteline J. P.	5		West part	Main	42	Alley	198	70	100			4		174			25	149	Main lot of lot	39			
Same	7		S.W. Cor.	Main	46	Alley	198	70		160		5		235			34	201		40			
King Emma	4		All	Main	74	25	198	70	90		200	8		368			53	315		40			
Lombard Henry	14		All	Main	66		198	60	100			4		164			23	141		41			
Loor Delilah E.	25		All	Railroad	66		198	50				1		51			7	44		41			
Larowe Sarah J.	44		All	Cross	66	Third	222 75	40	150			4		194			28	166		42			
Lehman Christian	3		S.W. Cor.	Main	24		60	20	500 stone			11		531			76	455		42			
Same	5		S.E. Cor.	Main	22	50		10	150 stone			14		194			28	166		42			
Same	19		E. Side	Main	54	00	198	50	700	100		17		867			125	742		43			
Same	67		All	Railroad	57	00	198	30	180			5		215			31	184		43			
Loder Aaron	65		All	Railroad	57	00	198	30	100			3		133			19	114		44			
McBane Charles	13		All	Main	66	Cross	198	60	600	100		16		776			112	604		45			
Mitchell Daniel	51		All	Cross	66		198	40	100			3		143			20	123		45			
Mitchell Anna E.	47		W. Side	Main	8		198	10				1		11			1	10		46			
Same	48		E. Side	Main	42		198	40				1		41			5	36		46			
Maddox Philip	26		All	Cross	66		222 75	40				1		41			5	36		46			
Same	28		All	Cross	66	First	222 75	40				1		41			5	36		47			
Same	46		All	Main	66	Railroad	198	60	240			6		306			44	262		47			
Same	47		E. Side	Main	58		198	50	100			3		153			22	131		48			
Marshall Henry	2		All	Main	74	25	Cross	198				2		72			10	62		49			
Mundy Thomas	10		E. Side	Main	60		198	60	260			7		327			47	280		49			
Munthorn Sarah M.	64		All	Railroad	66	First	198	40	180			5		225			32	193		50			
Pyers M. E.	63		All	Railroad	66		198	40				1		41			5	36		50			
Perry Edson	1		All	Main	74	25	Cross	198	100	120		6		306			44	262		51			
Perry John	68		All	Railroad	57		198	30				1		31			4	27		51			



In Whose Name Assessed.	DESCRIPTION OF PROPERTY.							Value of Lots. Dollars.	Value of all Buildings.			Total Value of Lots and Buildings. Dollars.	Amount Added or Deducted by Co. Board of Equalization.		Total Value as Equalized by Co. Board. Dollars.	Amount Added or Deducted by State Board of Equalization.		Total Value as Equalized by State Board. Dollars.	REMARKS.
	No. of In-Lot.	No. of Out-Lot.	What Part.	Street.	Feet.	Street.	Feet.		Houses.	Mills.	Other Buildings.		Added Dollars.	Deducted Dollars.		Added Dollars.	Deducted Dollars.		
									Dollars.	Dollars.	Dollars.								
Reed Lulu	62		All	Railroad	66		198	50			100		150	3	153	22	131		52
Robinson A. M.	80		All	cross	57		214 50	20					20	1	21	3	18	Seems to be too short	52
same	81		All	cross	57		214 50	20					20	1	21	3	18		53
same	82		All	cross	57	Fourth	214 50	20					20	1	21	3	18		53
Robinson Mary J.	59		All	cross	66		198	30			120		150	3	153	22	131		54
Stiner M.	31		All	Railroad	66	First	198	40			100		140	3	143	20	123		54
same	33		All	Railroad	66		198	40					40	1	41	5	36		55
Shawalter Joseph	16		All	Main	66	Alley	198	60			190		240	5	255	36	219		55
Snodgrass Melissa	3		East part	Main	50 25		198	70			130		200	4	204	29	175		56
State of Ohio (J. M. Franklin)	52		All	cross	66	First	198	40					40	1	41	5	36		56
Walker Thomas	6		All	Main	74 25	Alley	198	70					70	2	72	10	62		57
Wetzel Francis G.	17		All	Main	66		198	60			200		260	6	266	24	242		57
same	19		W. part	Main	12		198	10					10	1	11	1	10		58
Wetzel Michael	27		All	Railroad	66		198	50					50	1	51	7	44		58
same	29		All	Railroad	66	Alley	198	40					40	1	41	5	36		59
							620				870		1760	34	1494	195	1299		



Assessment of Lots in the Town of

DESCRIPTION OF PROPERTY.

Value of Lots.

In Whose Name Assessed.

No. of In-Lot.

No. of Out-Lot.

What Part.

Street.

Feet.

Street.

Feet.

Dollars.

			Corporation Lands						
			44 2/3 A					2210	
			Lots						
			Page 13					1270	
			" 14					1590	
			" 15					620	
			Total Lots					3480	
			Total Lands and Lots					5690	

Union County, Ohio, for the Year 1890.

Value of all Buildings.			Total Value of Lots and Buildings.	Amount Added or Deducted by Co. Board of Equalization.		Total Value as Equalized by Co. Board.	Amount Added or Deducted by State Board of Equalization.		Total Value as Equalized by State Board.	REMARKS.
Houses.	Mills.	Other Buildings.		Added Dollars.	Deducted Dollars.		Added Dollars.	Deducted Dollars.		
			H							
1140	3000	250	6600	57		6657				
1860		200	3330	78		3408				
4170		680	6440	144		6584				
840			1460	34		1494				
6870		880	11230	256		11486				
8020	3000	1130	117830	313		18143				



DARBY TP.  
UNION COUNTY  
1890.