

ROCKY FORK DITCH

No 679

LANSON B. HARVEY, ENG.

WASHINGTON TOWNSHIP 1904

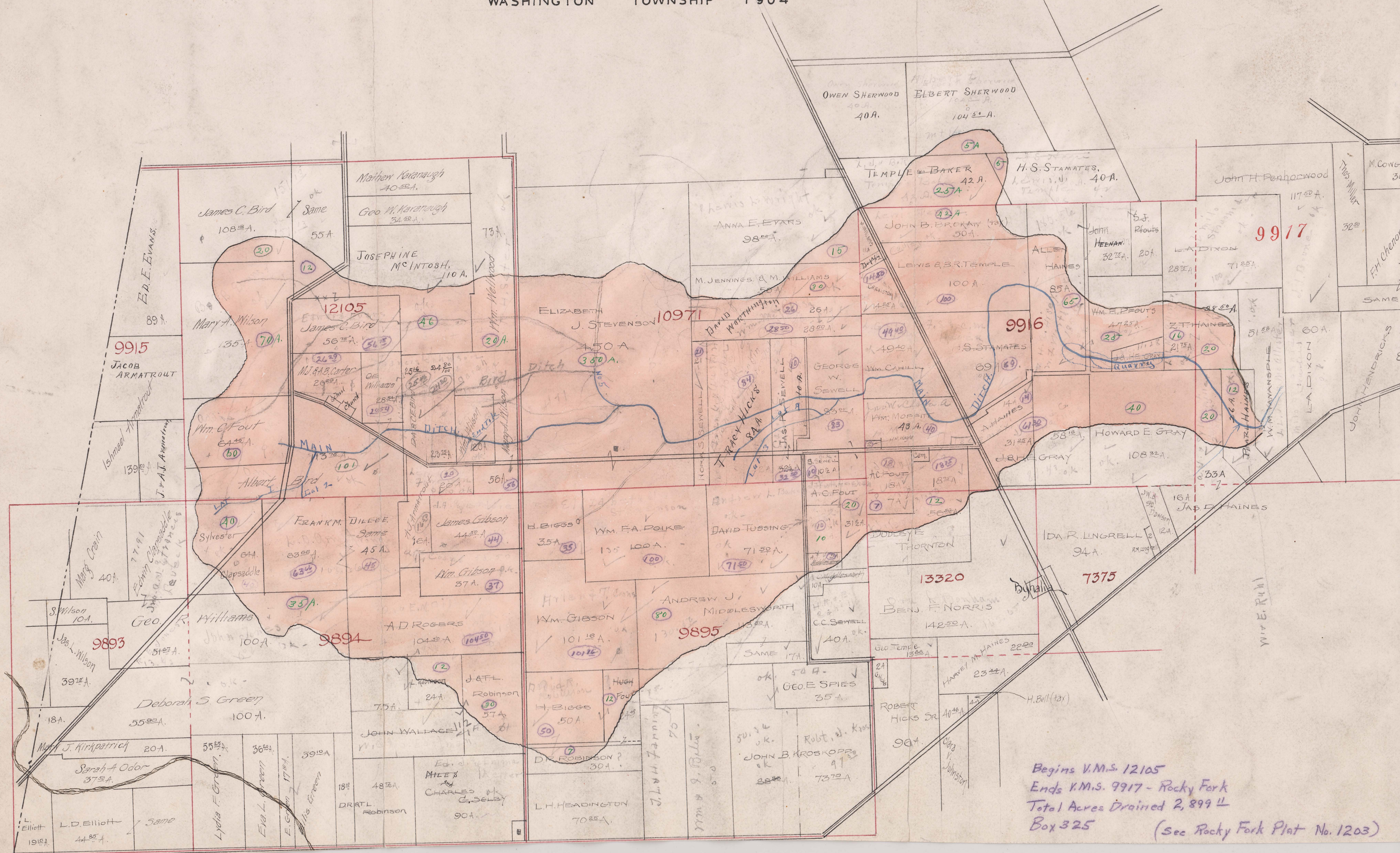

Begins V.M.S. 12105
 Ends V.M.S. 9917 - Rocky Fork
 Total Acres Drained 2,899 1/2
 Box 325 (See Rocky Fork Plat No. 1203)