

ROCKHOLD JT. DITCH

Former Name

SPANGLER JOINT DITCH

No 706

Washington Twp
8th

Alvi Graham - Engr

1905

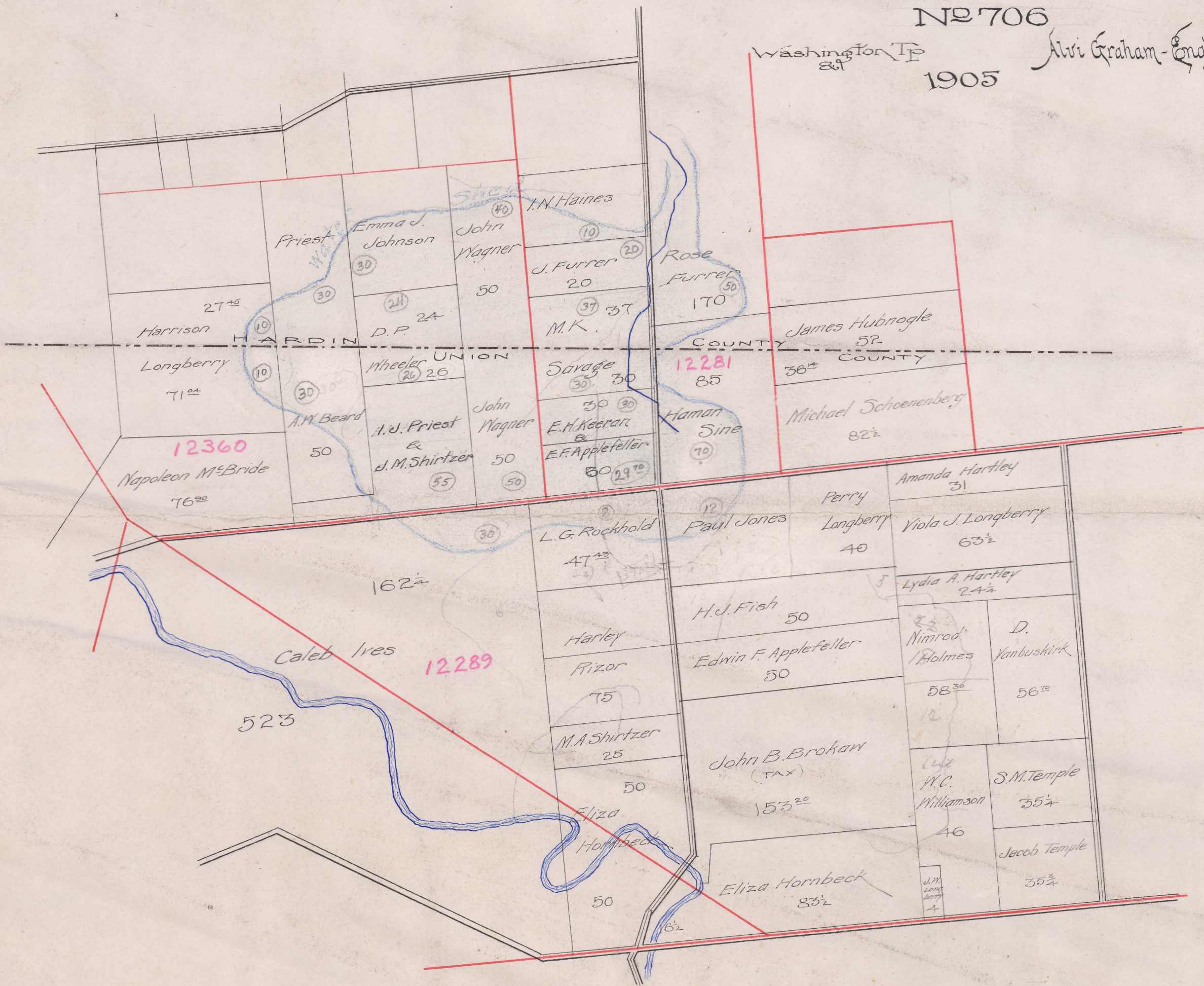

Begins V.M.S. 12281 - Washington Twp. Union Co.
 Ends Hale Twp. Hardin Co.
 Total Acres Drained 379^{7/8} Union Co.
 Box 327