

WATTS DITCH N<sup>o</sup> 731.

1906

Harvey, Eng.

TAYLOR TOWNSHIP

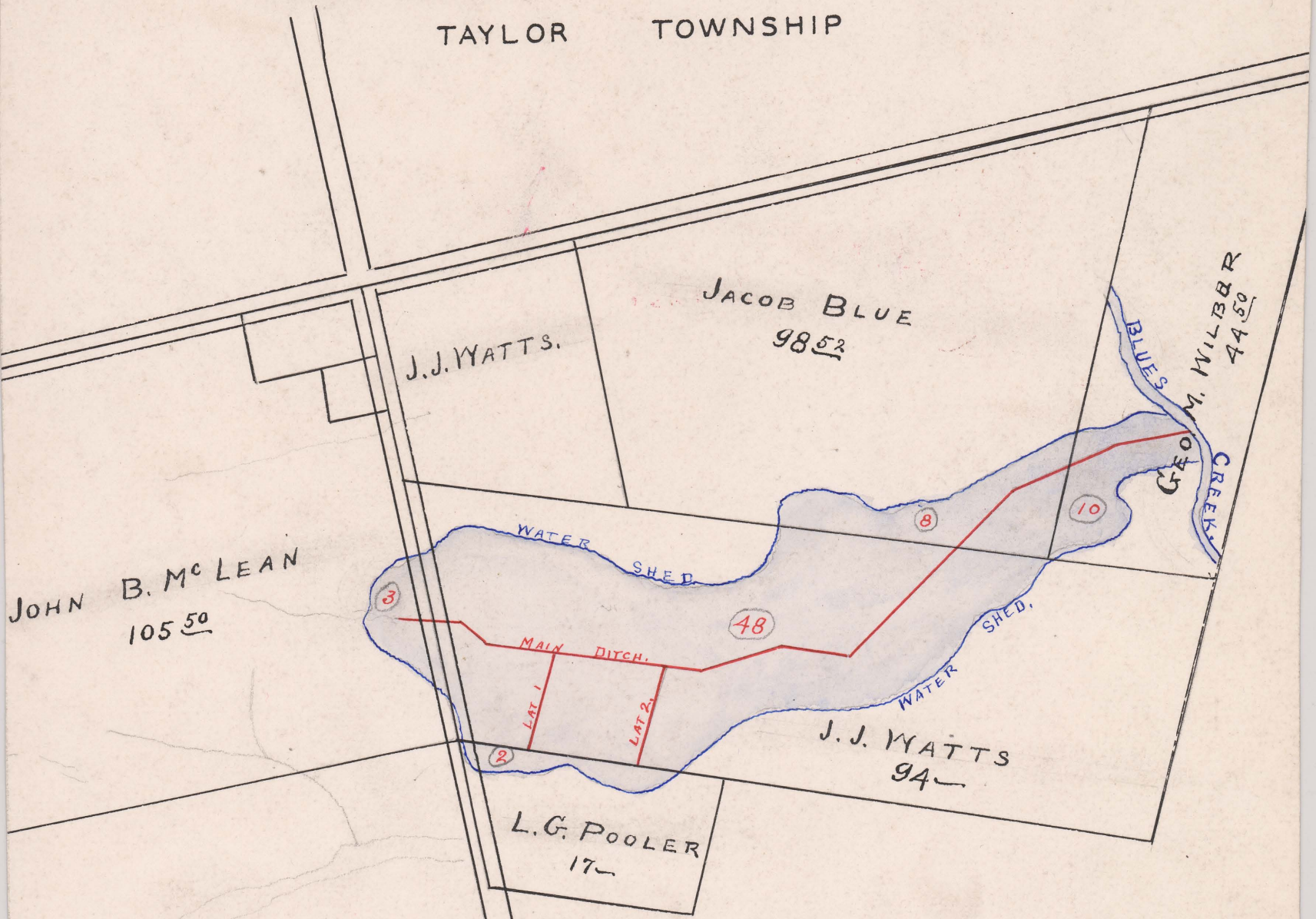

FILED  
 DWIGHT BEDWARDS  
 JAN 27 1906

Begins V.M.S. 829  
 Ends V.M.S. 829 - Blues Creek  
 Total Acres Drained 71.50  
 Box 330