

Marysville D. 1. 1. # 331

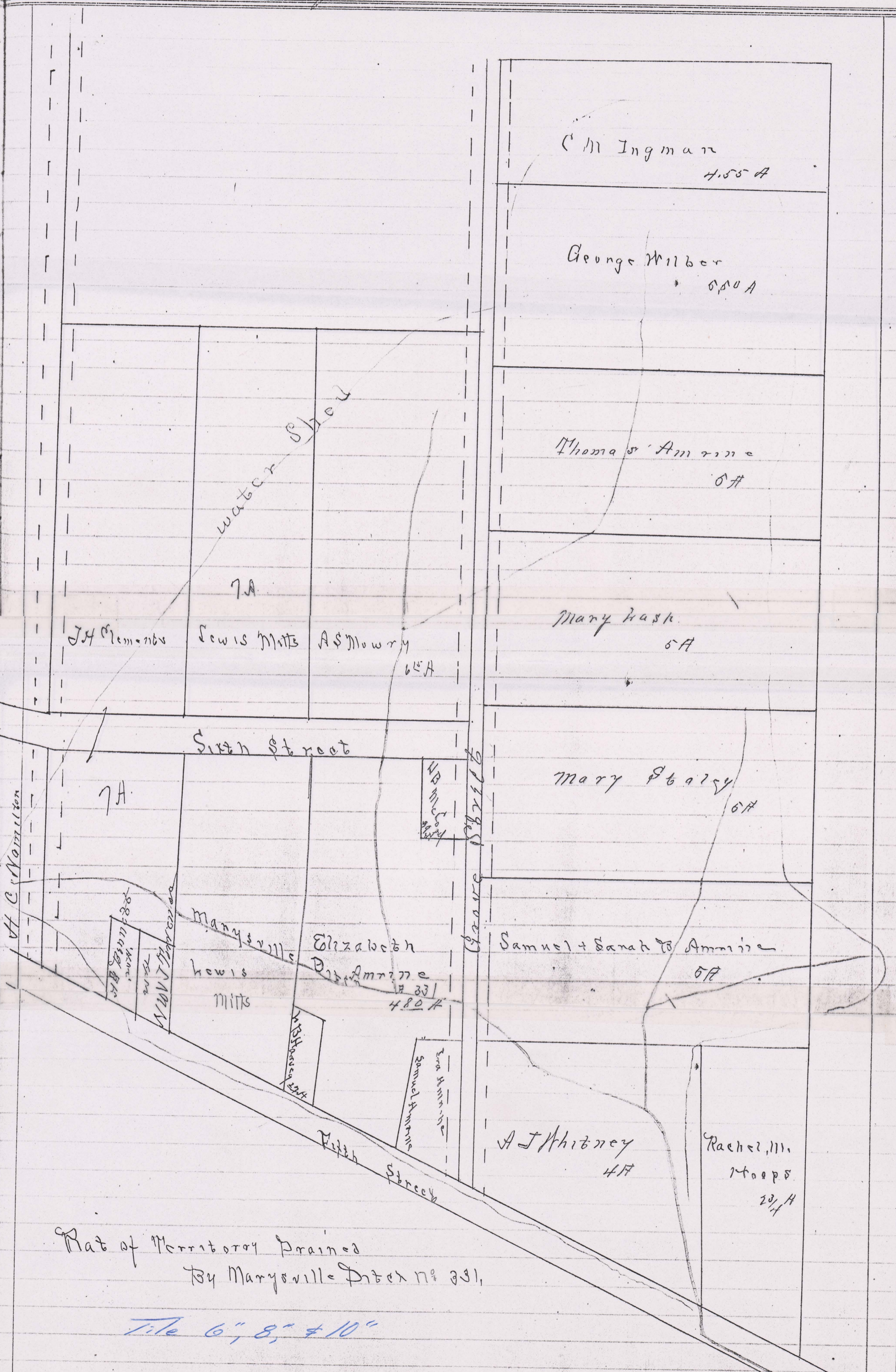

C. M. Ingman
4.55 A

George Wilber
6.50 A

Thomas & Annine
6 A

Mary Nash
5 A

Mary Stacey
6 A

Samuel & Sarah B. Annine
5 A

A. J. Whitney
4 A

Rachel M. Hoops
2 1/4 A

water shed

Sixth Street

Fifth Street

Grave Strip

J. H. Clements
Lewis Mitts
A. S. Mowry
6 1/2 A

W. W. J. M.
W. W. J. M.
W. W. J. M.

Marysville
Elizabeth
Annine
Lewis Mitts
4.80 A

Samuel Annine
Eva Annine

Part of Territory Drained
by Marysville Ditch No. 331.

File 6", 8", & 10"