

ANDERSON DITCH NO. 1143

LIBERTY TWP.

- 1922 -

W.P. Beightler Co. Eng.

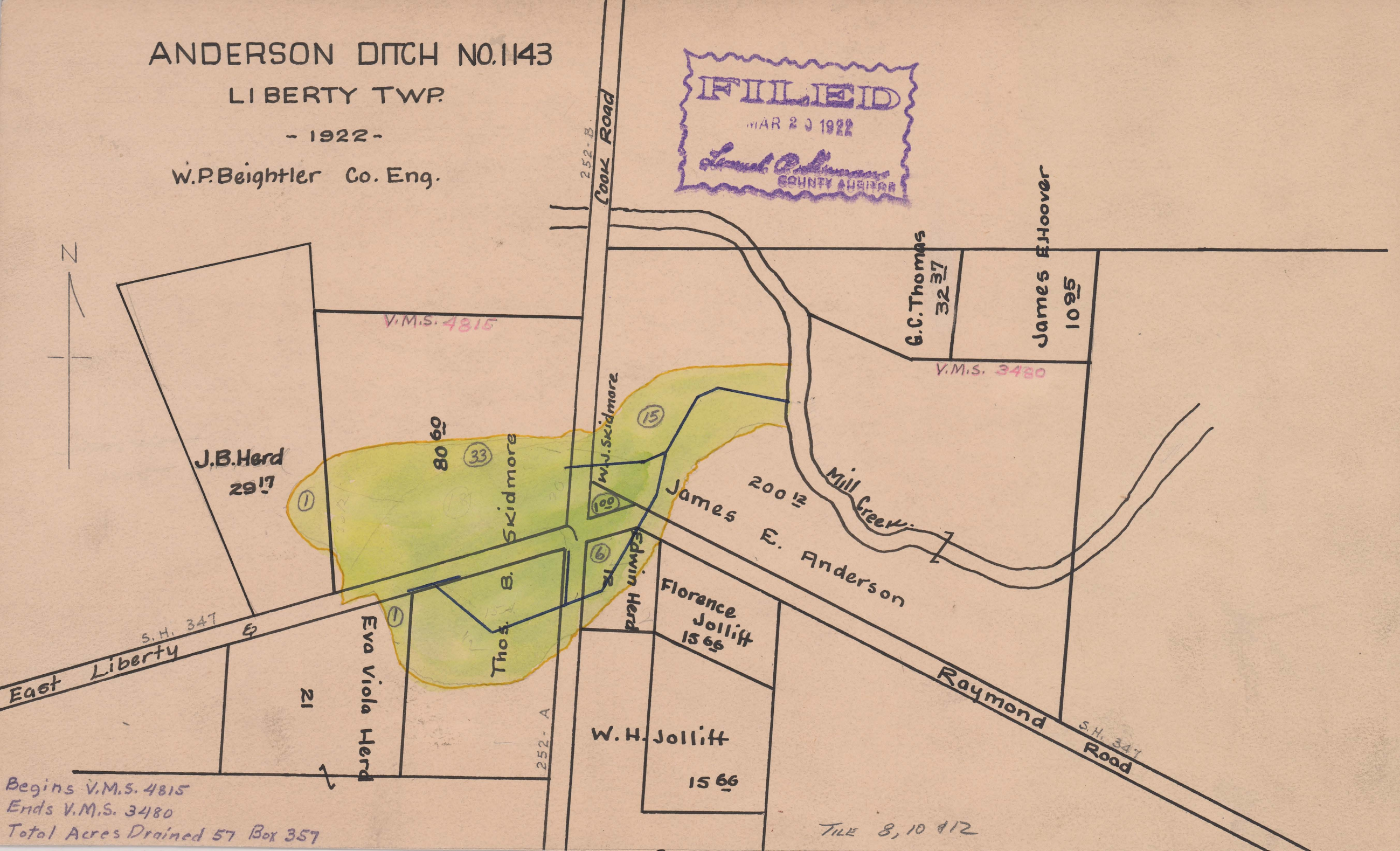

V.M.S. 4815

G.C. Thomas 32 37

James Hoover 10 95

V.M.S. 3480

J.B. Herd 29 17

80 60

Thos. B. Skidmore

W.J. Skidmore

James E. Anderson 200 12

Mill Creek

Edwin Herd

Florence Jollitt 15 69

W.H. Jollitt 15 66

Raymond

S.H. 347 Road

S.H. 347

East Liberty

Eva Viola Herd

21

252-A

252-B

Begins V.M.S. 4815
Ends V.M.S. 3480
Total Acres Drained 57 Box 357

TILE 8, 10 & 12