

O'BRIEN DITCH N°600

J. C. Kennedy, Engineer

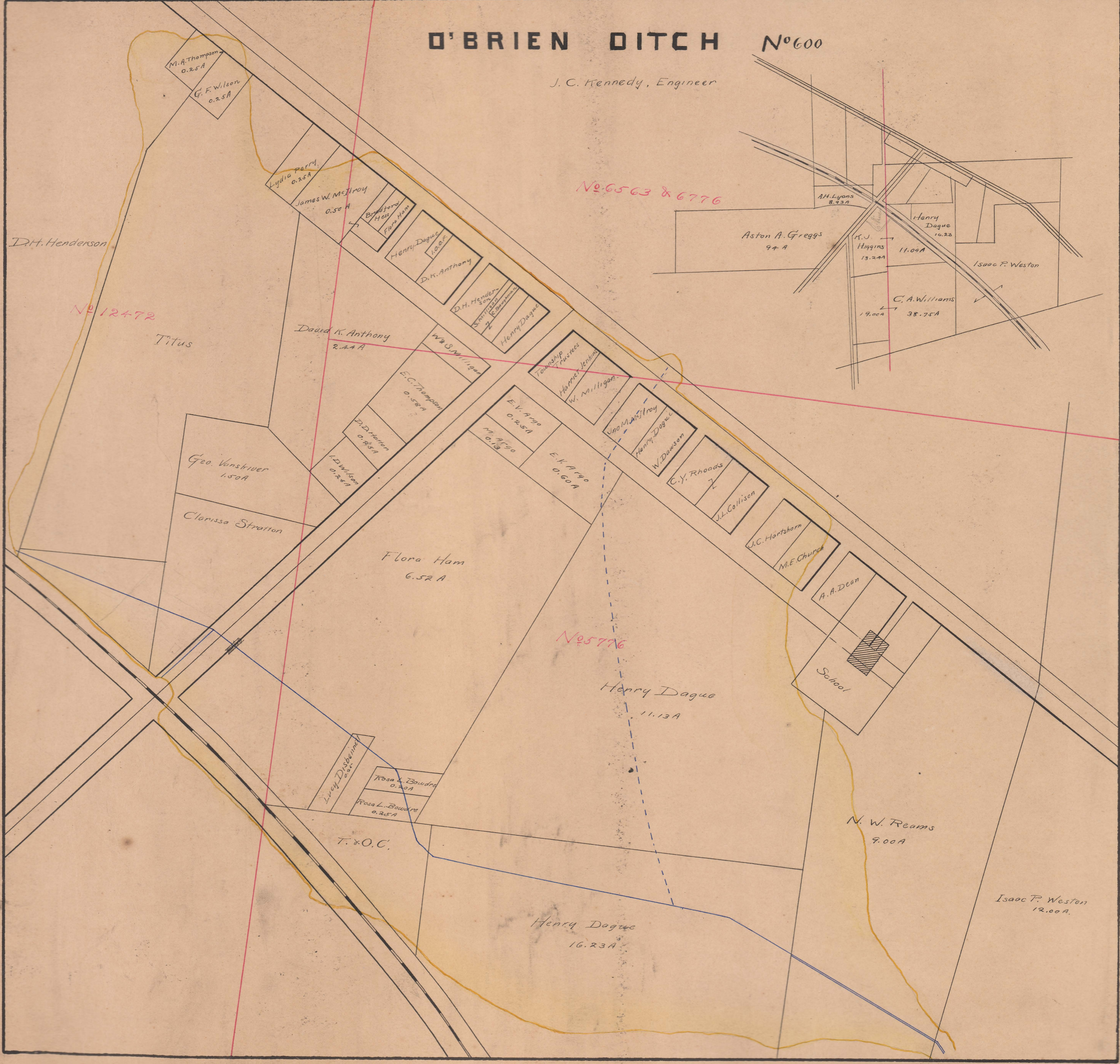

M.A. Thompson
0.25 A
G.F. Wilson
0.25 A

Lydia Perry
0.25 A
James W. McIlroy
0.50 A

Henry Dague
10.00 A
D.K. Anthony

D.H. Henderson
W.D. Milligan
Henry Dague

David K. Anthony
2.44 A

E.C. Thompson
0.58 A
D.D. Horton
0.25 A

Geo. Vanstriver
1.50 A

Clarissa Stratton

Flora Ham
6.52 A

E.V. Argo
0.25 A
M.A. Argo
0.13 A
E.K. Argo
0.60 A

W. Dawson
Henry Dague

C.Y. Rhoads
J.L. Collison

J.C. Hantshorn
M.E. Church

A.A. Dean

School

N.W. Reams
9.00 A

Isaac P. Weston
12.00 A

Henry Dague
16.23 A

Rosa L. Baudre
0.20 A
Rosa L. Baudre
0.25 A

T. & O.C.

No. 6563 & 6776

No. 12472

No. 5776

A.H. Lyons
8.93 A

Aston A. Gregg
9.4 A

H.J. Higgins
13.24 A

Henry Dague
16.23 A

C.A. Williams
19.00 A

Isaac P. Weston

O'BRIEN DITCH

Liberty Twp.

No 600 (1901)

J. C. Kennedy, Engineer

No 6563 & 6776

No 12472

Titus

No 5776

Henry Dague

11.13A

T. & O. C.

Henry Dague

16.23A

M.A. Thompson
0.25A
G.F. Wilson
0.25A

Lydia Perry
0.25A

James W. McIlroy
0.50A

Burford Hess
Flora Ham

Henry Dague
1.00A

D.K. Anthony

D.H. Henderson
0.50A

Henry Dague

David K. Anthony
2.24A

W.R. Smilgen

E.C. Thompson
0.58A

Henry Dague

E.V. Argo
0.25A

M. Argo
0.19A

E.V. Argo
0.60A

Henry Dague

W. Dawson

C.Y. Rhoads
2

J.L. Collison

J.C. Hartsorn

M.E. Church

A.A. Deen

School

N.W. Reams
9.00A

Geo. Vanstriver
1.50A

Clarissa Stratton

Flora Ham
6.52A

Lucy Disbennet
0.25A

Rosa L. Bowdre
0.25A

Rosa L. Bowdre
0.25A

Isaac P. Weston
12.00A

Aston A. Greggs
9.7A

A.H. Lyons
8.93A

Henry Dague
10.22

H.J. Higgins
13.24A

C.A. Williams
38.75A

Isaac P. Weston

D.H. Henderson

