

WOLF RUN

DOVER TOWNSHIP

NO. 1234 JULY 1929

ALVI GRAHAM COUNTY SURVEYOR

Begins V.M.S. 5504

Ends V.M.S. 4065

Total Acres Drained 464.19

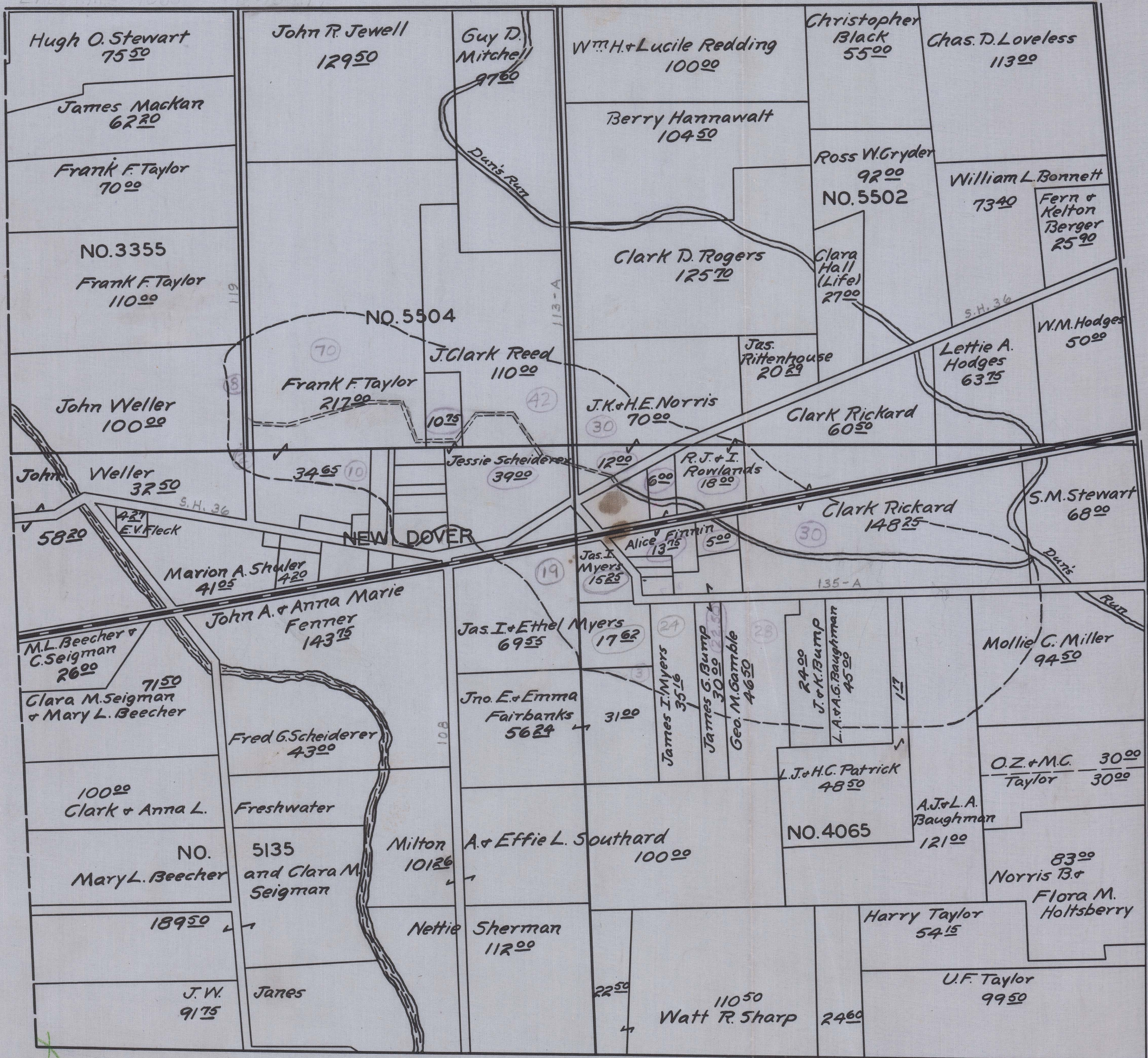

TAYLOR DITCH NO. 607- LATERAL NO. 6 OR WOLF RUN REPAIR NO. 1234 NEW DOVER

SCALE - 10 POLES - 1 INCH

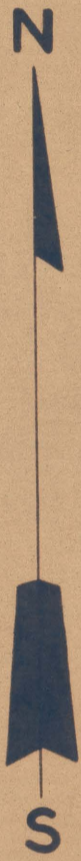

NO. 5135

B.F. & Anna Anthony
217⁰⁰

Frank F Taylor
34⁶⁵

B.F. & Anna Anthony

2⁰⁰

3⁰⁰

2⁰⁰

Ed Freshwater
4¹³

1⁰⁰

Geo H Stoll
1⁶⁰

4⁰⁰

R S Thompson
5⁴²

1⁰⁰

Board of Education
1⁰⁰

1⁰⁰

Adrian M Taylor
1⁰⁷

Jessie O Scheiderer
39⁰⁰

50

Jno Hush Jr
50

50

Adrian M Taylor
7⁵

20 19
Anna M Fogle

M.E. Church

STREET

18 17
Ella Roberts

16 15
Dwight & Hazel B.

14 13
Jno Hush Jr

12 11
Glenn Gladys Kirby

10 9
Arthur Gibson

8 7
Jesse O Scheiderer

4 3 2 1

Nellie C Johnston

J N Vining

J K & H Norris

25 26
Ralph Myers

27 28
Jno Hush Jr

29 30
Wm H Mitchell

31 32
Adrian M Taylor

33 34
Glenn Gladys Kirby

35 36
Lewis C Telsey

37 38
Arthur Gibson

39 40
R S Thompson

41 42
Jesse O Scheiderer

43 44
Jesse O Scheiderer

45 46
Jesse O Scheiderer

47 48
Jesse O Scheiderer

49 50
Jesse O Scheiderer

Valentine Ehrhard
Jeremiah Johnson
W M Brown
Susan M Gibson
M C Gambel
Marion Shuler
Chas & Eliza Shuler
Elias & Martha

DELAWARE - MARYSVILLE ROAD
I.C.H. NO. 238

57 56 55 54 53 52 51 50 49 48 47
Fanny H Shuler
Joseph Edeblute
Eugene
Edna Bice
C.C. & Imo M Kune
A.C. Myers
M.E. Church
C.F. & O McGracken
James H & Dora Rittenhouse
W.E. & Effie J Kirby
W.E. & Effie J Kirby

42 41
John Hush
John Hush

40 39
M.E. Church
Ed Freshwater

38 37
John Hush
J.G. Stoll

36 35
John Hush
John Hush

34 33
John Hush
John Hush

32 31
John Hush
John Hush

30 29
John Hush
John Hush

28 27
John Hush
John Hush

26 25
John Hush
John Hush

24 23
John Hush
John Hush

22 21
John Hush
John Hush

20 19
John Hush
John Hush

18 17
John Hush
John Hush

16 15
John Hush
John Hush

14 13
John Hush
John Hush

12 11
John Hush
John Hush

10 9
John Hush
John Hush

8 7
John Hush
John Hush

6 5
John Hush
John Hush

4 3 2 1
John Hush
John Hush

Marion A Shuler
41⁰⁵

M.A. Shuler
4²⁰

C.C.C. & ST.L.
B.R.

John A. + Anna Marie Renner

Jas I. + Ethel Myers

8 7 6 5
Jas I. + Ethel Myers

Shuler



School



Depot