

GAULKE DITCH NO. 1147

UNION & DARBY TWP.
1922

W.P. Beightler - Co. Eng.

FILED
SEP 28 1922
Linn County Auditor

No - 1147

Scheiderer
Ditch # 1131

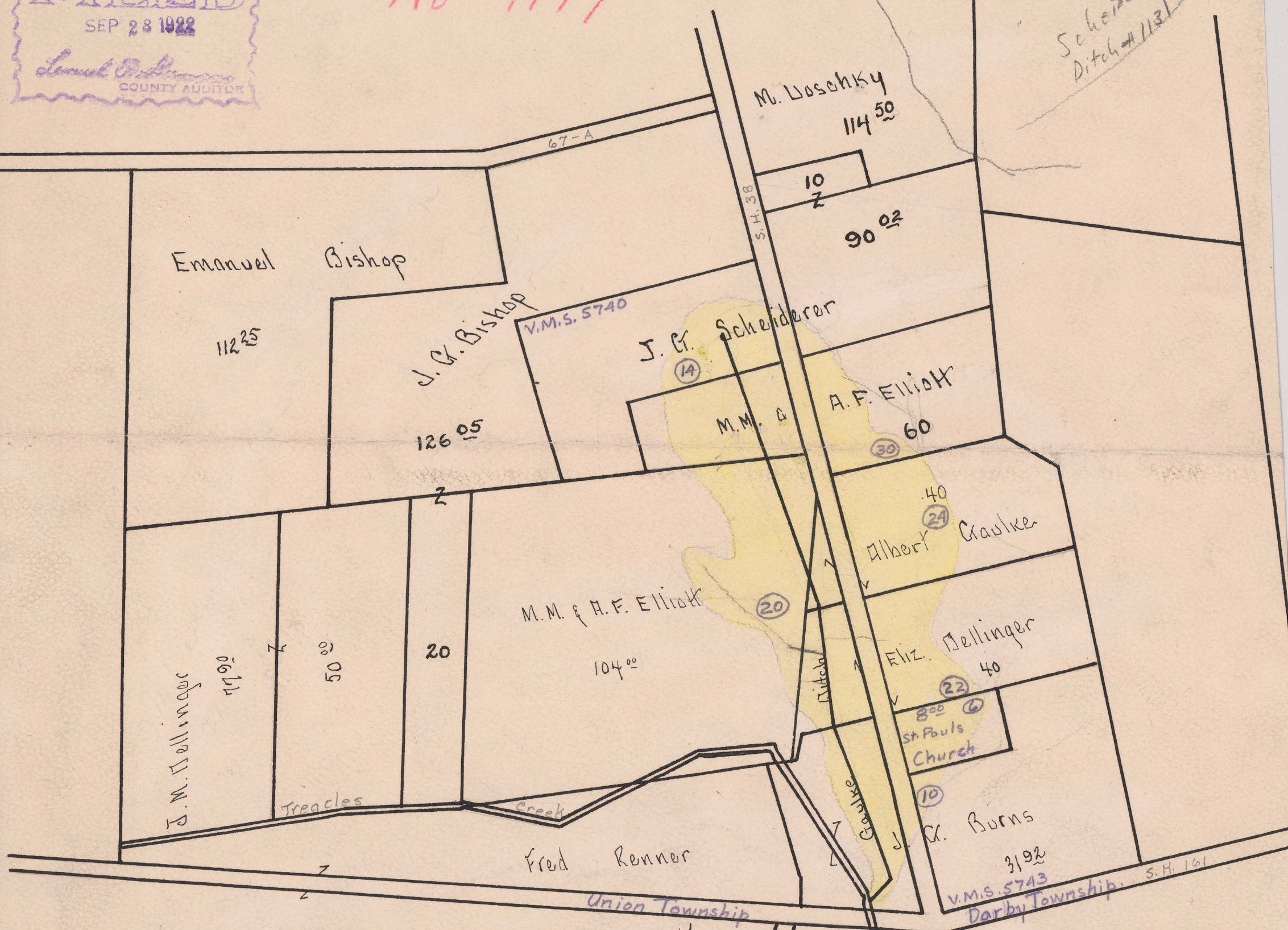

Co. Line
Begins V.M.S. 5740-Union Twp.
Ends V.M.S. 5743 - Darby Twp. Treasles Creek
Total Acres Drained 127.00
Box 360.

X