

HAWN DITCH

Darby Tp.

No. 933

—1909—

FILED
BERT J. SHELTON
NOV
29
1909
COUNTY AUDITOR
UNION COUNTY, O

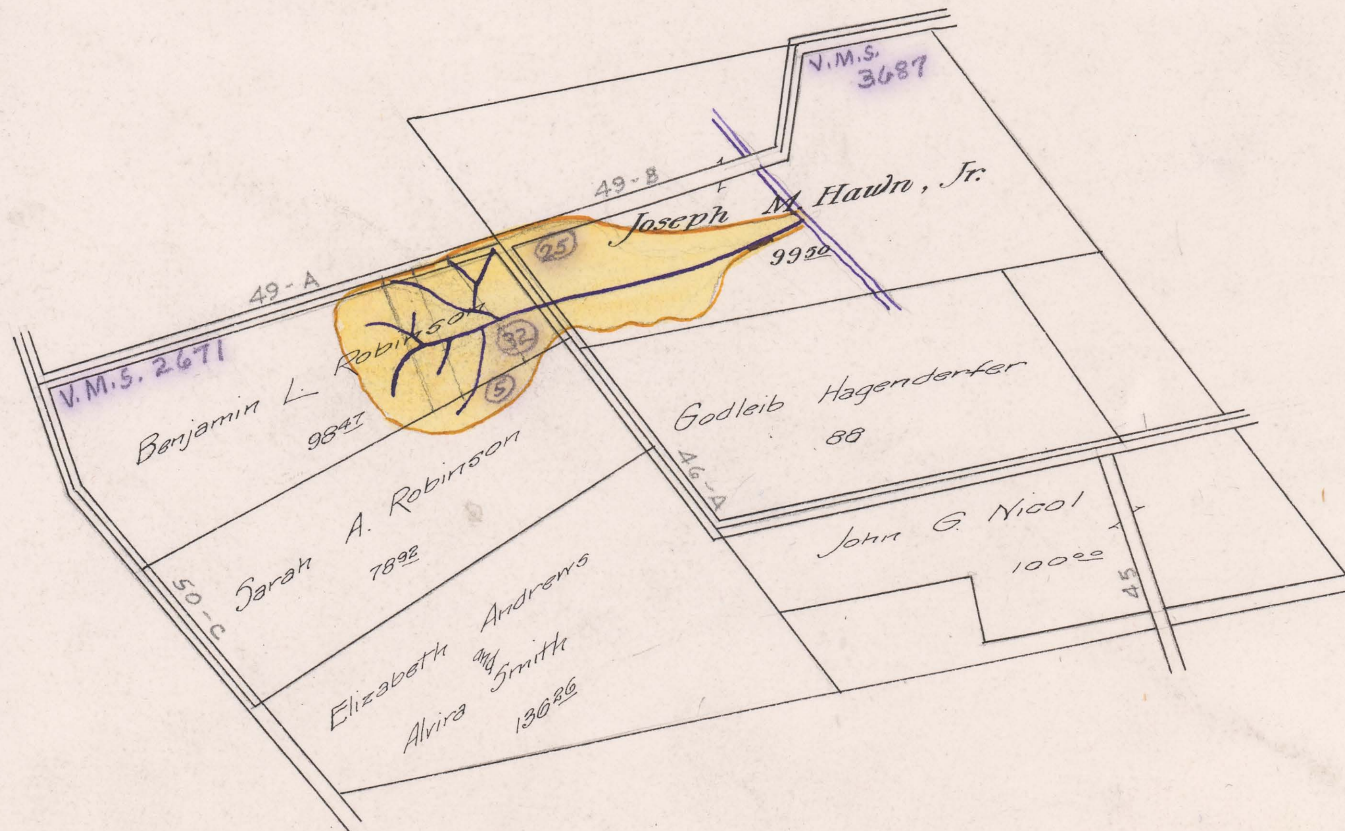

Tile 5", 6", 7", 8", 9", 12"

Begins V.M.S. 2671

Ends V.M.S. 3687

Total Acres Drained 62⁰⁰ Box 402