

Darby Township

MILLER DITCH

NO 688

L.B. Harvey, Eng.

DARBY TOWNSHIP 1904

FILED
 DWIGHT B. EDWARDS
 JAN 7 1905
 COUNTY AUDITOR
 UNION COUNTY O.

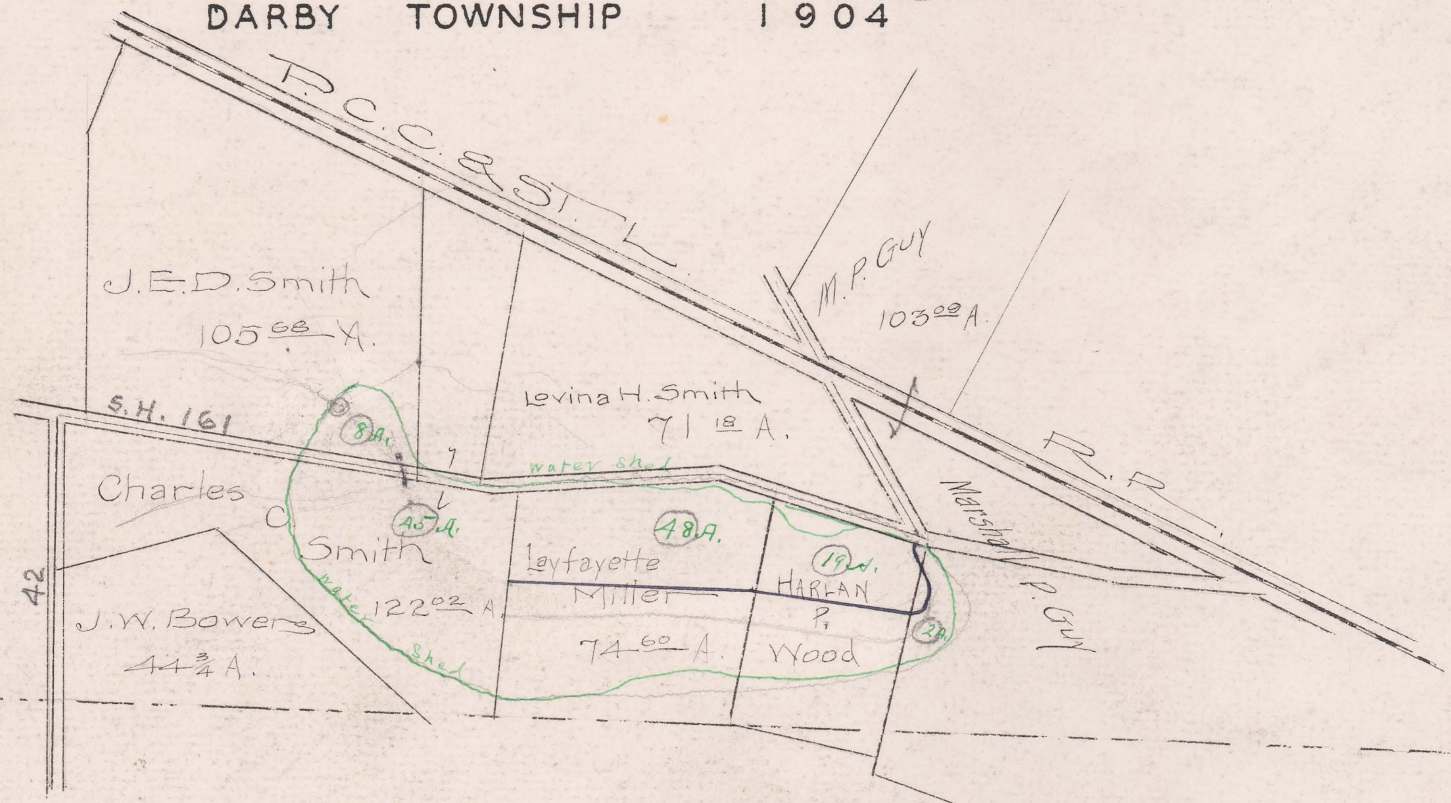

Begins V.M.S. 7751

Ends V.M.S. 3162

Total Acres Drained 122⁰⁰

Box 326

SCALE 10, 12, + 13 1/2"