

Bishop Ditch
No 689

Lanson B. Harvey, Engineer

DARBY & UNION TWPS.

1904

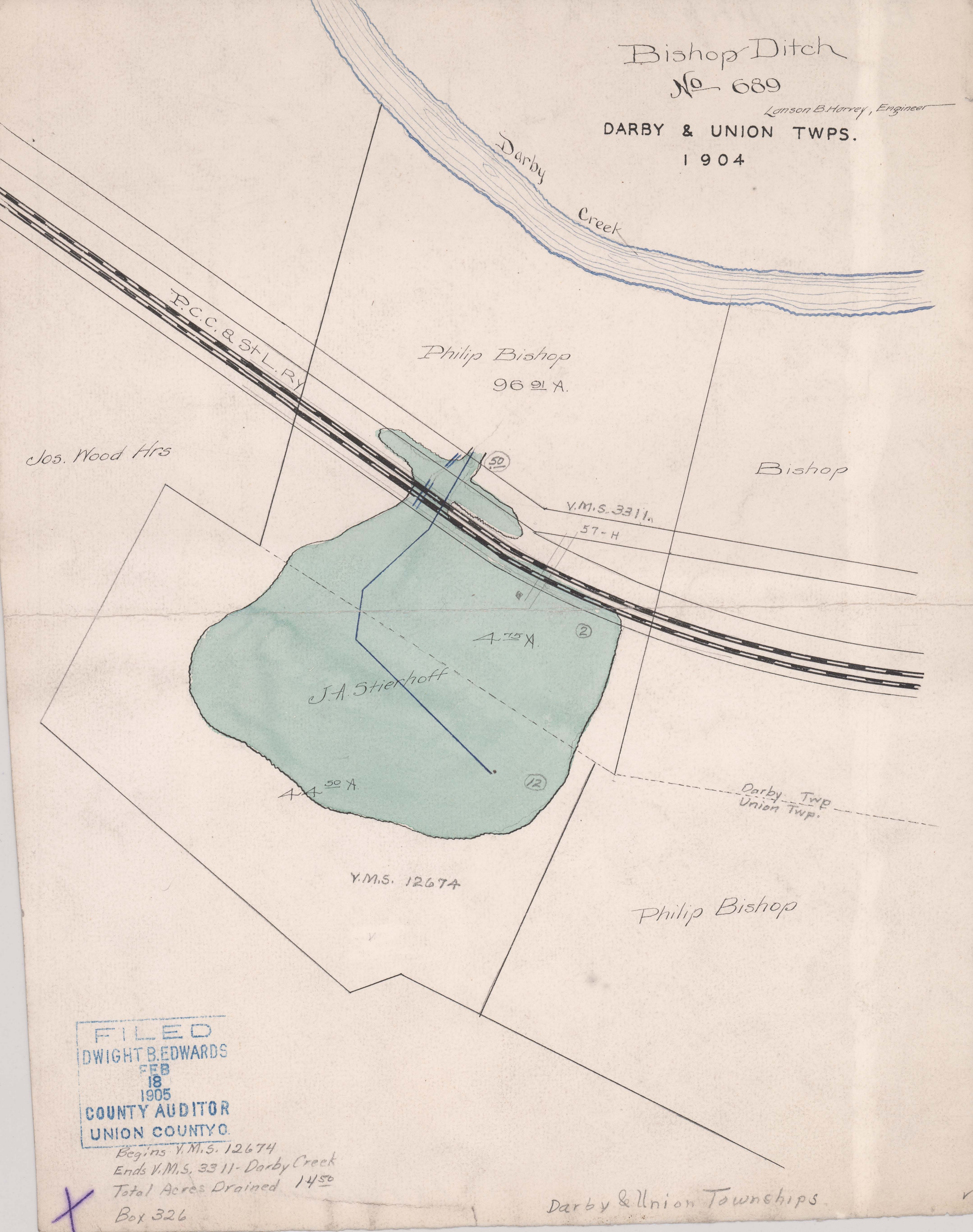

Jos. Wood Hrs

Philip Bishop
96 9/16 A.

Bishop

J.A. Stierhoff

4 7/8 A.

4 1/2 A.

V.M.S. 12674

Philip Bishop

Darby Twp
Union Twp.

FILED
DWIGHT B. EDWARDS
FEB
18
1905
COUNTY AUDITOR
UNION COUNTY O.

Begins V.M.S. 12674
Ends V.M.S. 3311- Darby Creek
Total Acres Drained 14 5/8
Box 326

Darby & Union Townships