

FILED
BERT J. SHELTON
DEC 27 1909
COUNTY AUDITOR
UNION COUNTY,

SMITH DITCH

Darby Tp.

- No. 926 -

- 1909 -

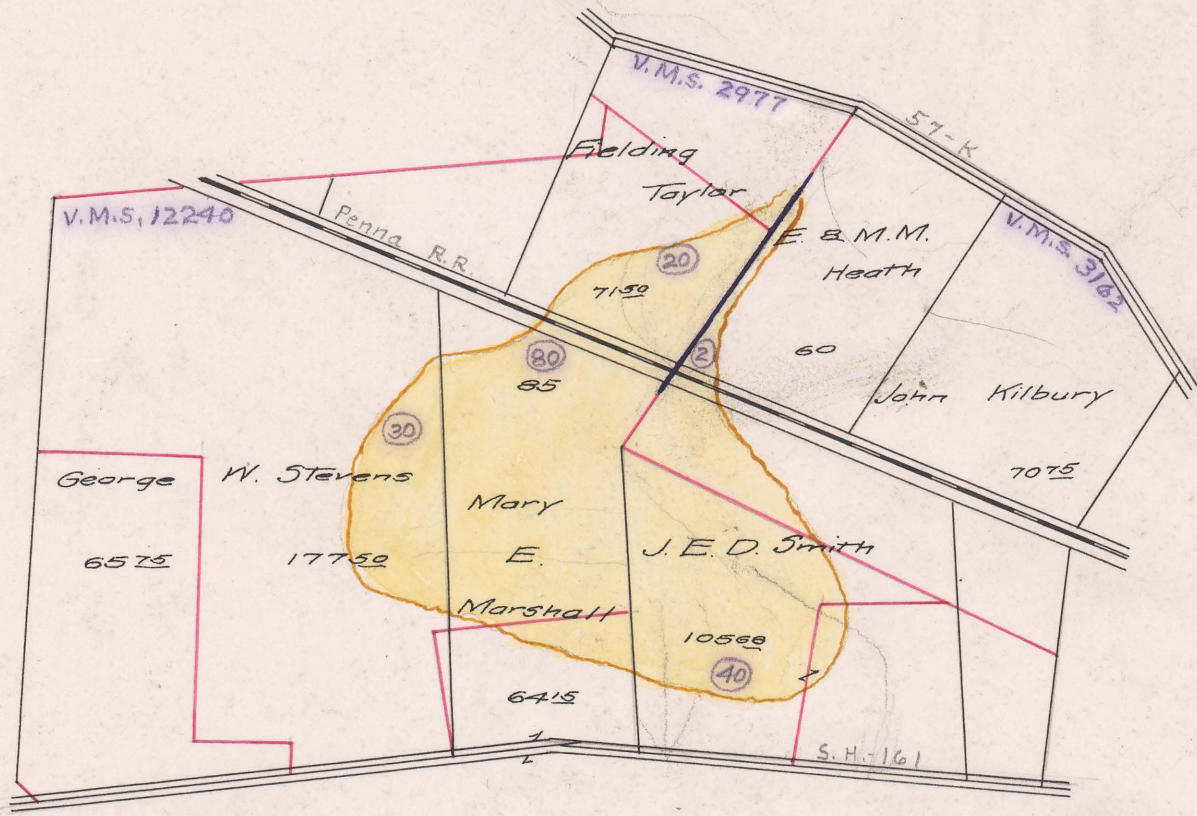

Begins V.M.S. 12240
Ends V.M.S. 3162 - Darby Creek
Total Acres Drained 172.00
Box 401