

REED DITCH NO. 1136

Taylor and Claibourne Townships

1921-22

W.P. Beightler, County Eng.

L.B. Harvey, Dep. Eng.

CLAIBOURNE TWP.

TAYLOR TOWNSHIP

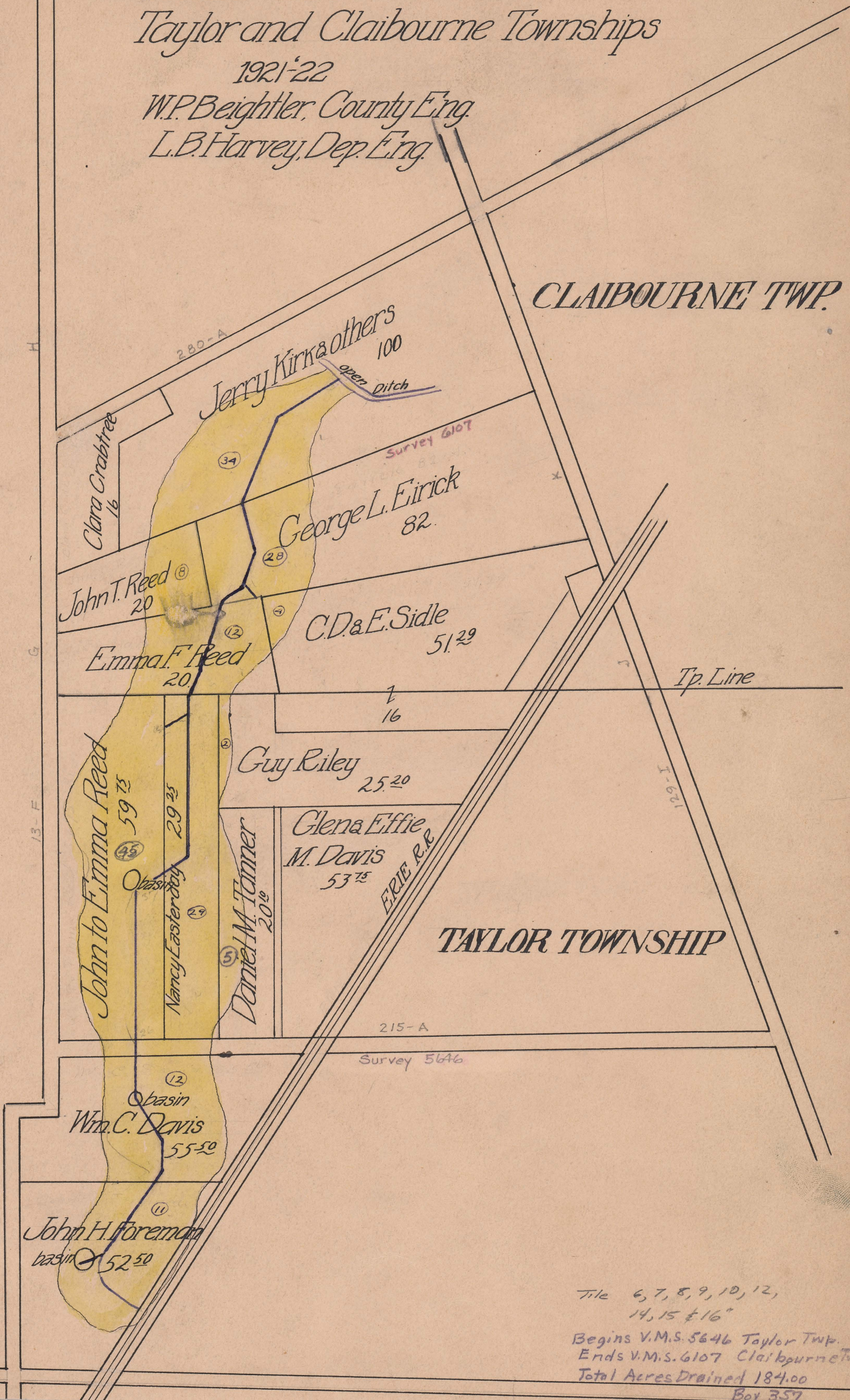

Tile 6, 7, 8, 9, 10, 12,
 14, 15 & 16"
 Begins V.M.S. 5646 Taylor Twp.
 Ends V.M.S. 6107 Claibourne Twp.
 Total Acres Drained 184.00
 Box 357