

TOWNSHIP

JACKSON

MARION COUNTY

COUNTY

DELAWARE

TOWNSHIP

YORK

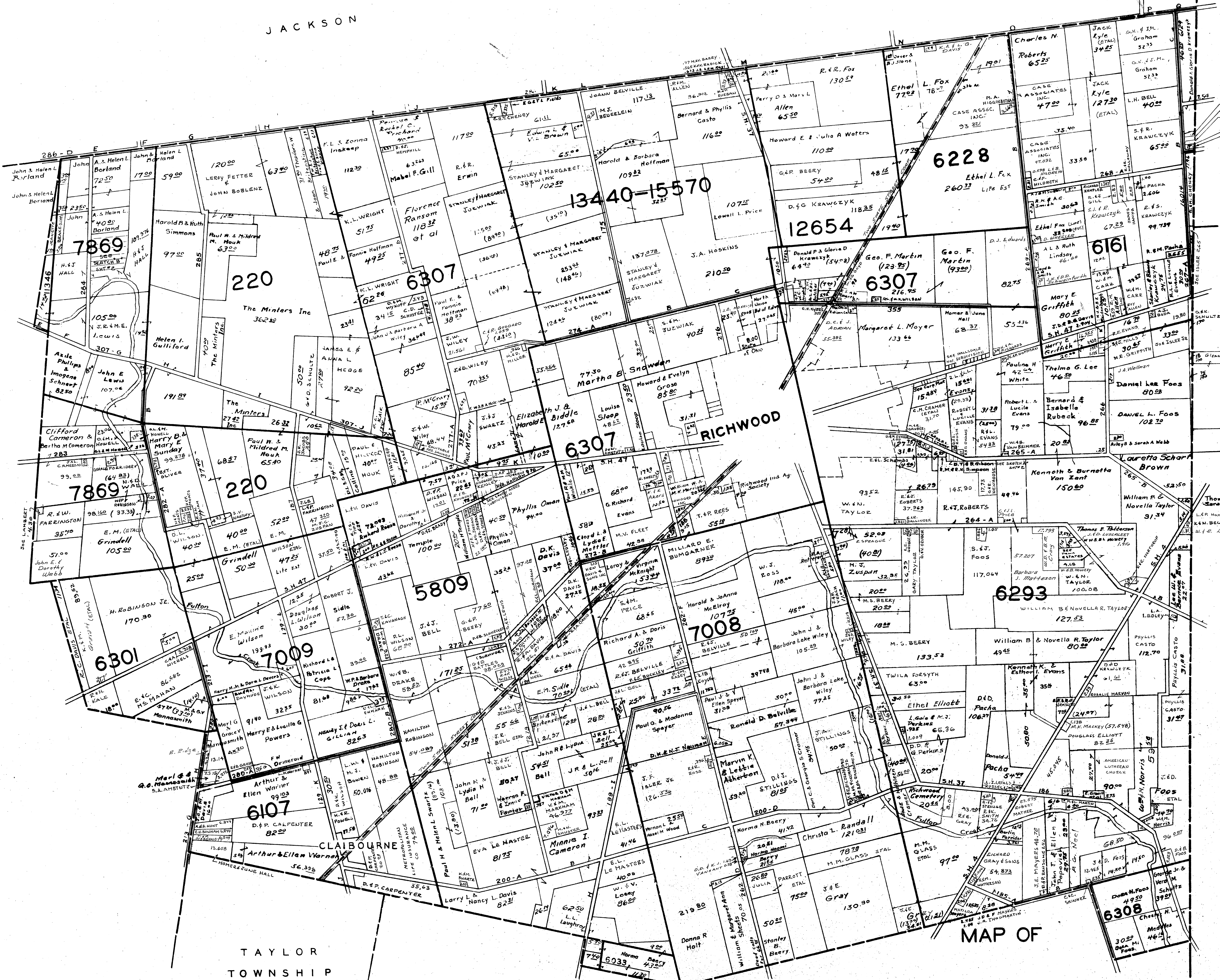
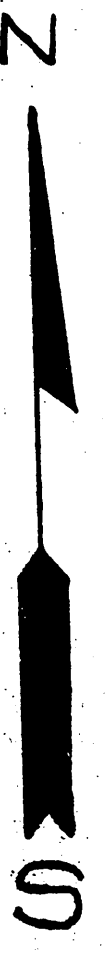

MAP OF CLAIBOURNE TOWNSHIP

UNION COUNTY

OHIO

SCALE - 4 IN. 1 MILE

CORRECTED Jan. 1 1982 CLAIBOURNE

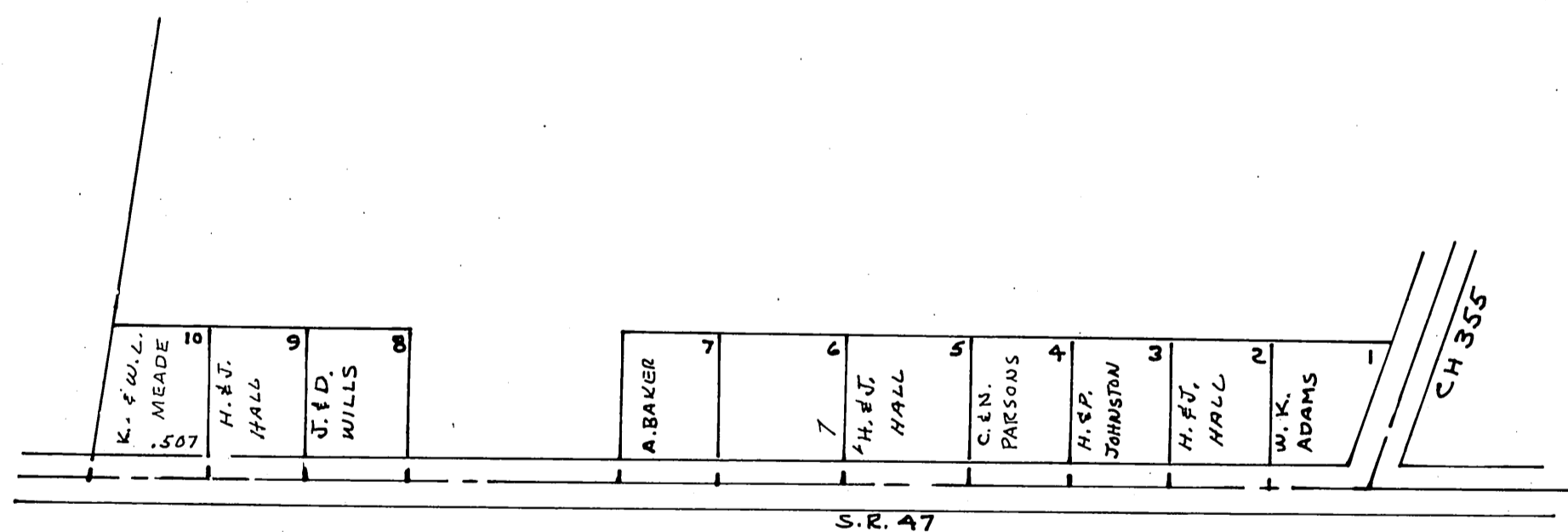

HALLSDALE No. 1 SUBDIVISION
V.M.S. 2293 1"=200'

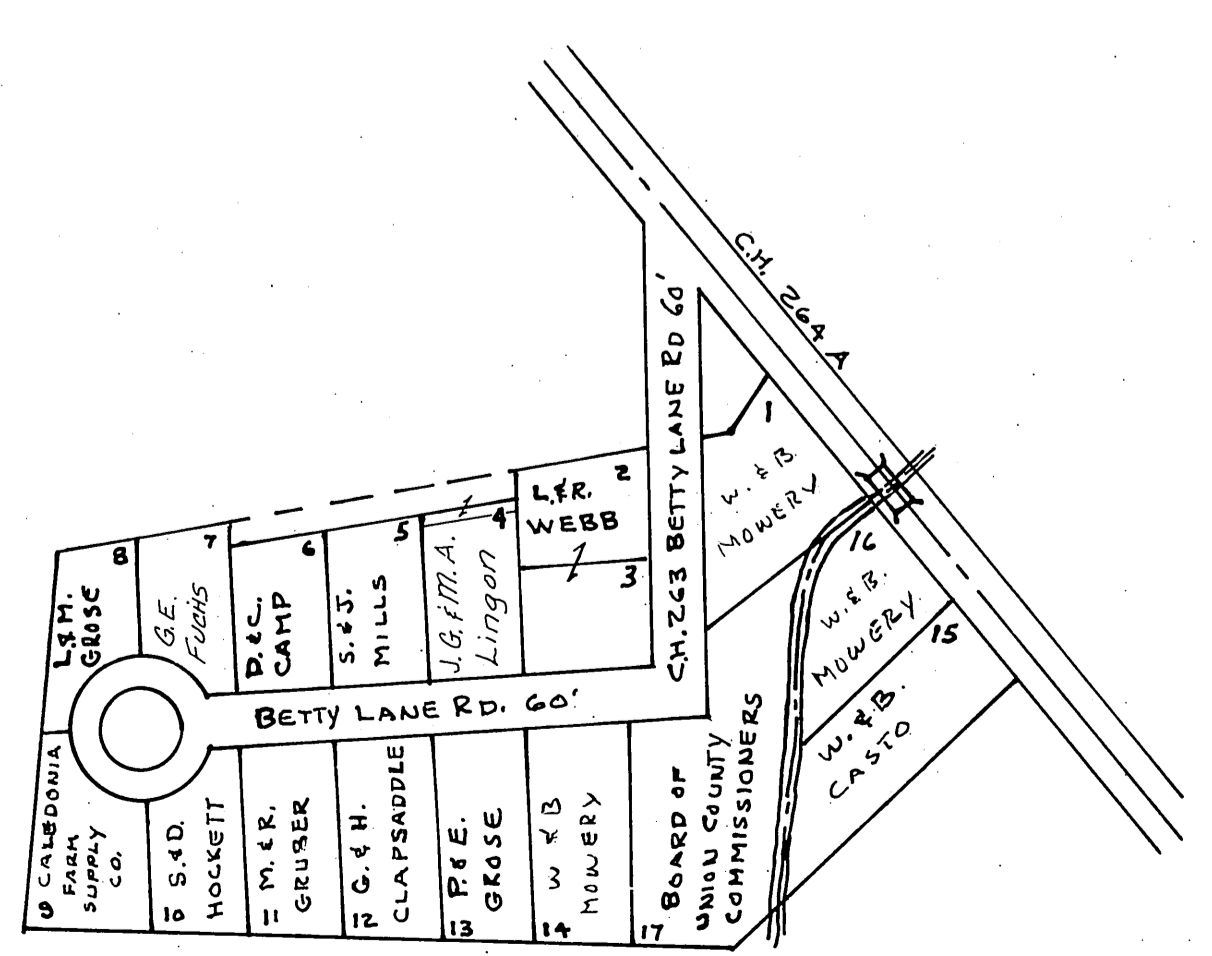

TAWA ESTATES
V.M.S. 6293 1"=200'

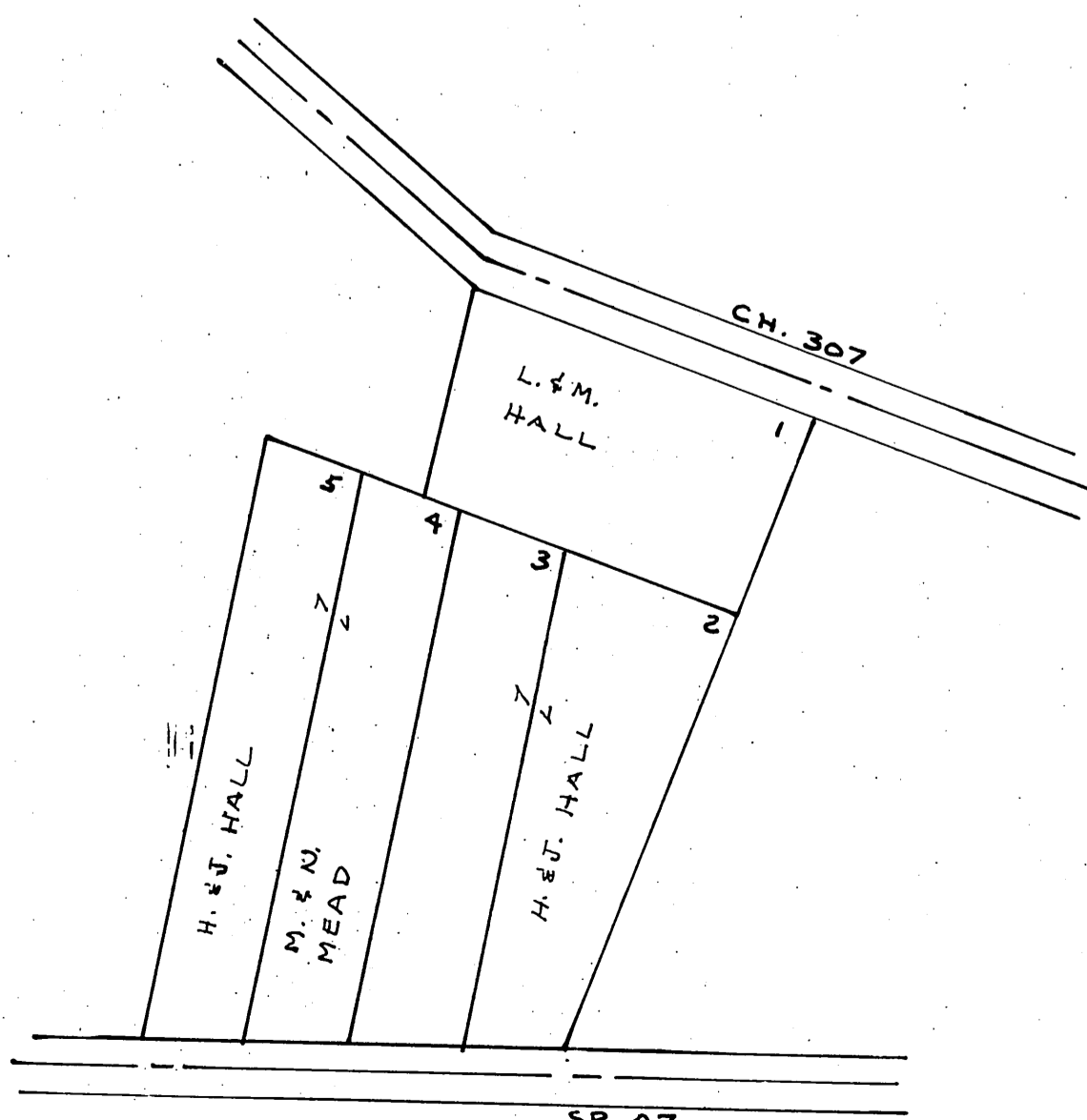

SANDY ACRES SUBDIVISION
V.M.S. 5809 1"=200'

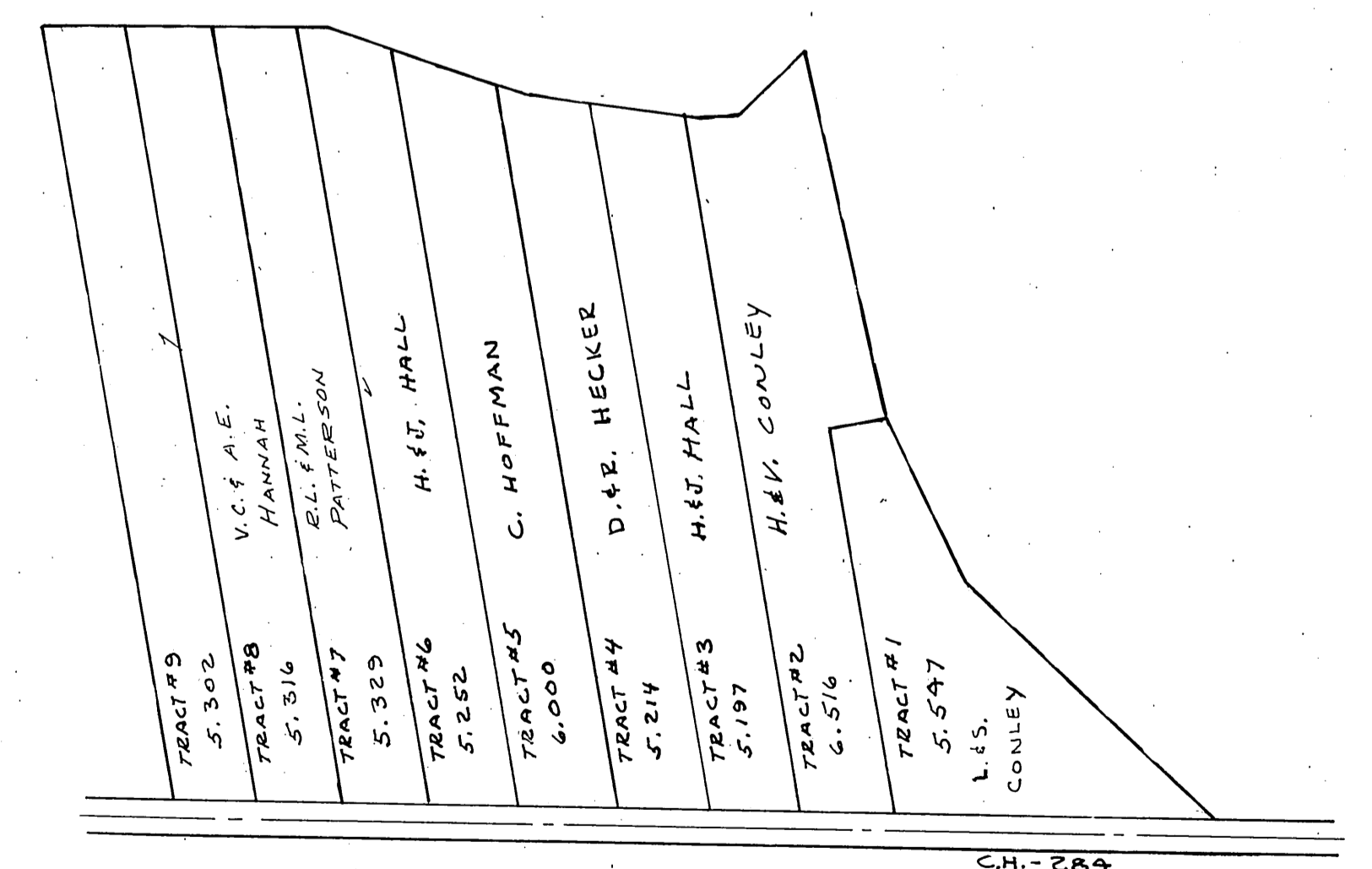

SKETCH "B"
V.M.S. 7869 1"=300'

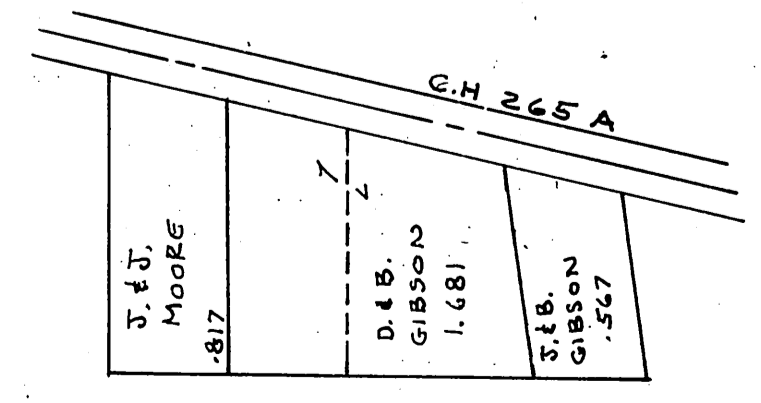

SKETCH "A"
V.M.S. 2293 1"=200'

**CLAIBOURNE
TOWNSHIP
SUBDIVISIONS**