

Clairborne

Owners Names

Part of No. 6293

The Lucy Wright part of B. Clairborne's Survey No. 6293-4267

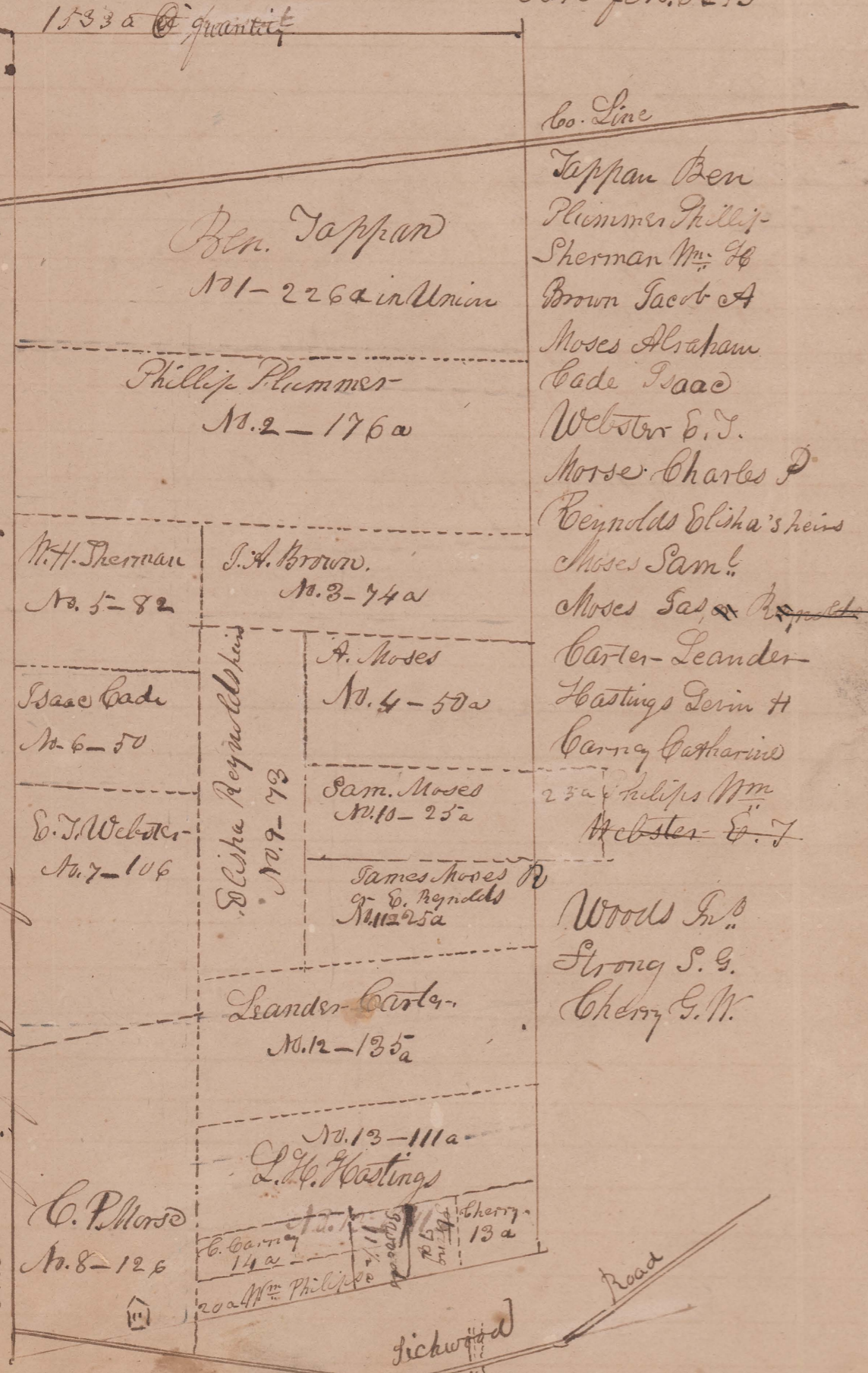

Clairborne
 Value
 Meadow
 Anything
 Total Value

		Value	Meadow	Anything	Total Value
1	226	2,25			508
2	176	3,00	15	10	528
3	55	3,50	10		192
3	74	3,00			222
4	50	3,50	15		175
6	50	4,25	12	10	212
7	106	2,50			265
8	126	3,00	50	10	1008
9	73	2,80	It is thought there is more land here		218
10	25	4,00	16		100 <small>see next p</small>
11	25	3,30	6		82 <small>stands in Reynolds name</small>
12	135	3,50			472
13	111	4,50	15	12	5499
13	14	3,50			49
13	20	3,00			60
13	1 1/2	7,00	6		80
13	7	5,50	Strong or some one else owns this		38
13	13	7,00			91
		1296	139	48	Total on page 4799

Clabourne

Owner's Names
No. 6293

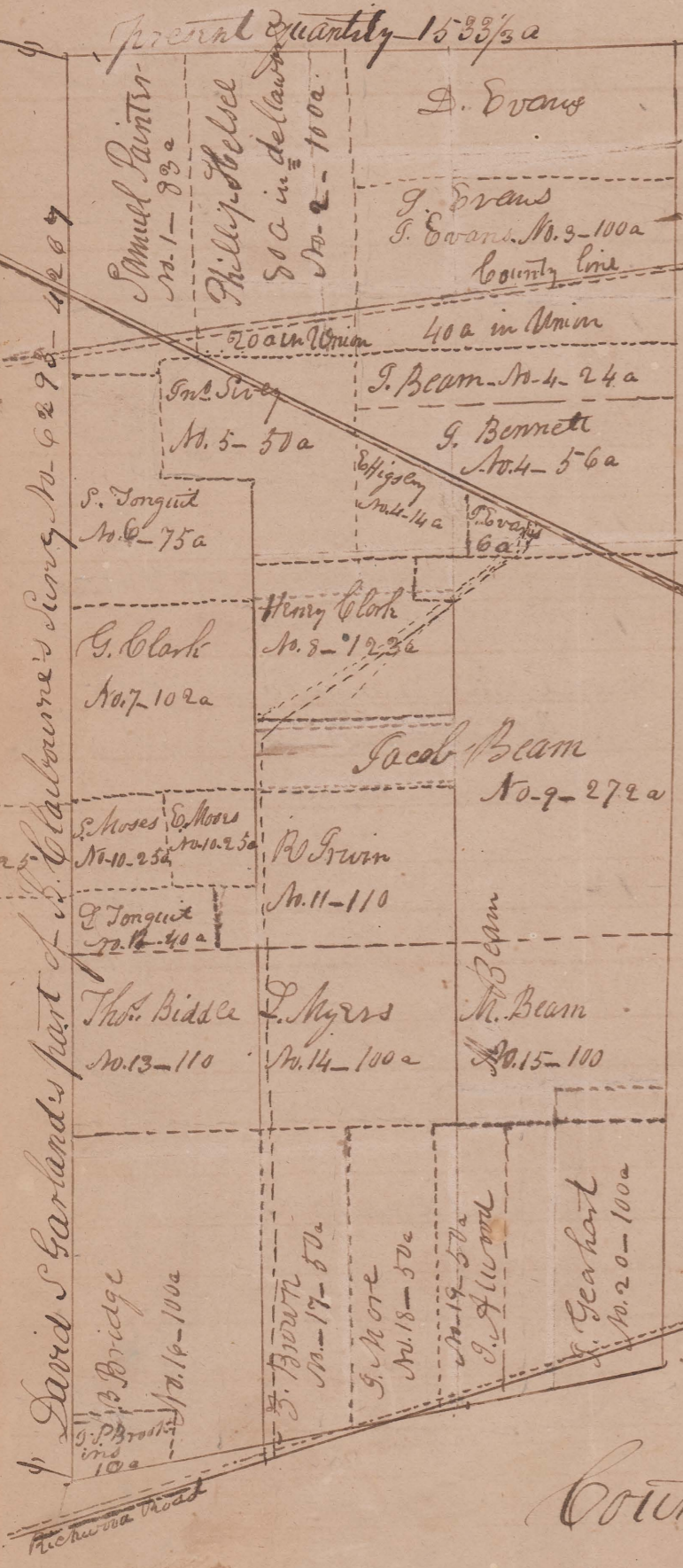

Present quantity 15 33 1/2 a

Samuel Painter No. 1-83a
Phily Helcel 50 a in de la...
No. 2-100a

G. Evans
J. Evans
J. Evans No. 3-100a
County line

Evans John
Beam Jacob
Bennet Jacob
Kigsy Elisha
Evans John
Sivey John
Tonguit Sarah
Clark Inc
Clark Henry
Beam Jacob

Union
40 a in Union

J. Beam No. 4-24a
G. Bennett No. 4-5-6a
S. Tonguit No. 6-75a
G. Clark No. 7-102a
Henry Clark No. 8-123a
Jacob Beam No. 9-272a
S. Moses No. 10-25a
W. Grwin No. 11-110
Thos. Biddle No. 13-110
J. Myers No. 14-100a
M. Beam No. 15-100

J. Brown No. 17-50a
S. More No. 18-50a
J. A. Wood No. 19-50a
S. Gearhart No. 20-100a

David S. Garland's part of Clabourne's Survey No. 6293-4287

Richmond Road

Main Road

County Line too

Clabourne

Lot	Acre	Value	Plowland	Meadow	Anything	Total value
1	15	2,00			Pd in W. Co. 37 ^d in Yellowed	30
2	20	2,75	14		Not taxed since 1840 or '41	55
3	40	4,75	9		Not taxed since 1840 or '41	190
4	24	3,25	7			78
4	56	2,50	7	7		252
4	14	5,00	5			70
4	9	5,00	5			30
5	50	3,50	12	8		175
6	75	3,50	10	5		262
7	102	6,00	45	15		612
8	128	4,40	20	4		541
9	272	3,50	30	20		952
		797	150	65		3247
10	25	4,00	12		25a on Lucy Wright	100
10	25	3,00				75
12	40	3,50	5	5		140
11	110	4,75	18	12		522
13	110	4,75	28	9		522
14	100	3,75	10			375
15	100	2,75				275
16	100	4,75	20	20		475
16	10	5,00			Has not been on duplicate	450
17	50	5,00	20			250
18	50	4,25	12			212
19	50	4,50	15	3		225
20	100	6,00	27	12		520
		870	175	61		3731
		1667	3257	126	Total from page	7978

far west in the above plat

Clabourne

Owners Names

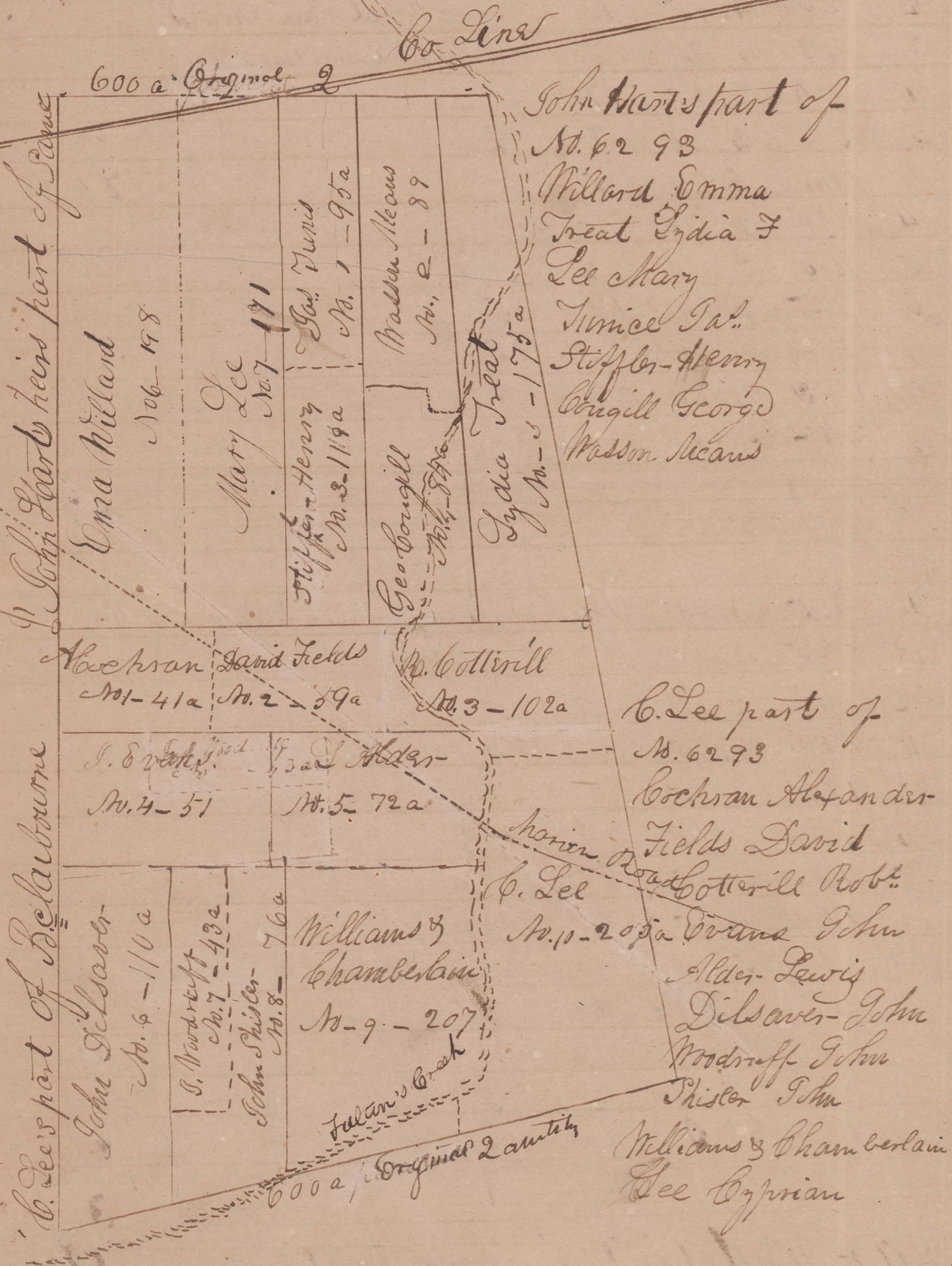

Clabourne

Acres Value Rowland Meadow Remarks Total Value

6	198	2,75			544
5	175	3,35			569
7	171	2,75			470
1	95	2,750			137
3	109	3,00			327
4	84	6,75	30	8	567
2	89	3,00			267
921			30	8	2891

1	41	3,40	4		139
2	59	5,50	10	9	295
3	102	6,30	35	20	643
4	51	4,00	16		204
5	72	7,00	22	8	564
6	110	76,75	30	12	742
7	43	4,75	8	7	204
8	76	5,50	34	4	418
9	207	5,00	16		1035
10	205	5,50	18	18	1127
966			193	78	5313

McWilliams & Clifton on No. 6308 - lies adjacent
 McWilliams Wm
 Clifton John

to the S. E. part of Clabourne - No 6293.				
139	3,75	8		521
24	3,00			72 = 593
2050		201	86	Total on page 8852

Clabourne

Owners Names

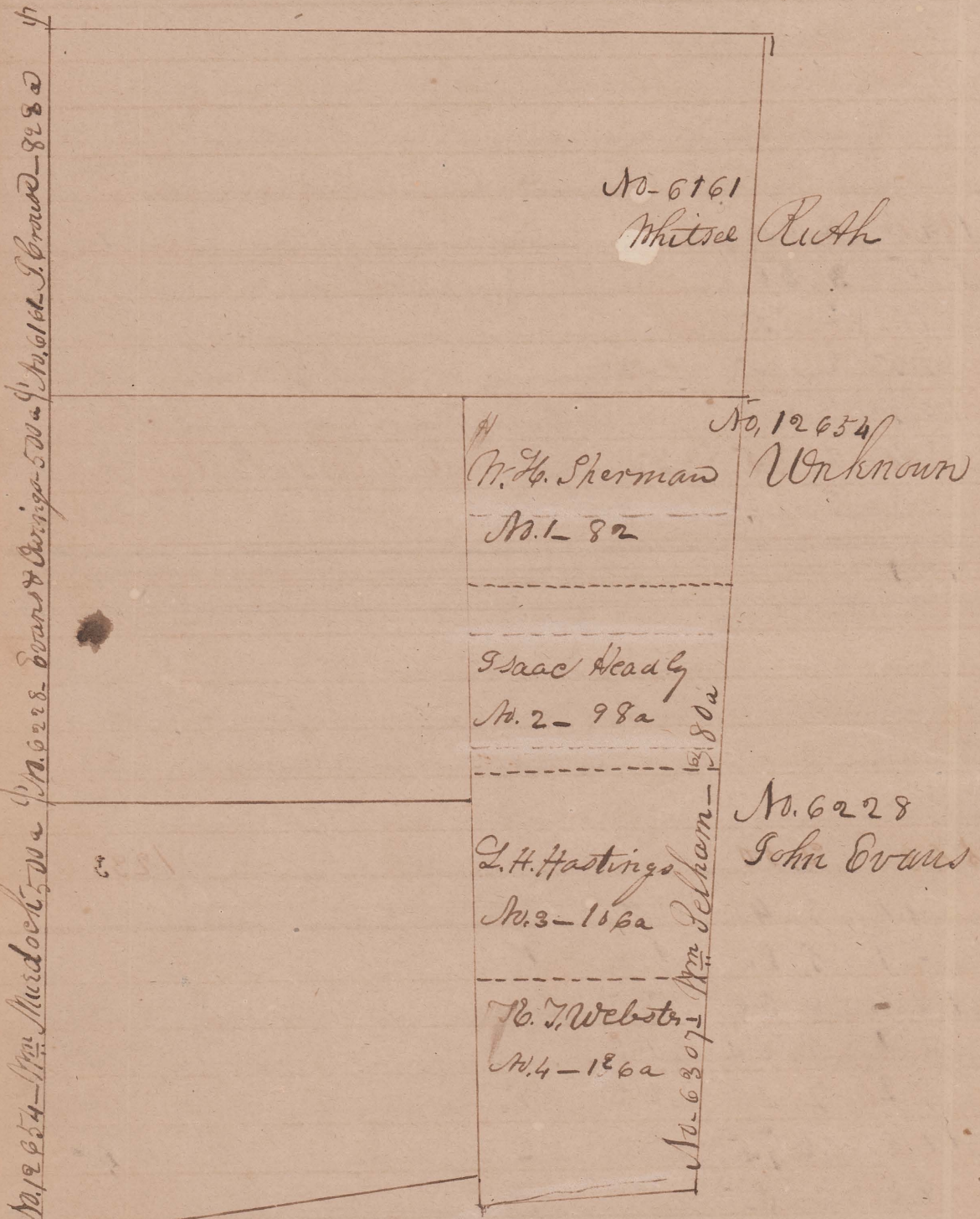

No. 6307
 Mr. H Sherman
 Healy Isaac
 Hastings L. H
 Webster E. J.

Acres Value of land Meadow Any thing Total Value

1046 2,00 2092

581 2,75 25 Said to be Mathit 21598

548 2,50 1233

1	82	3,75	10		307
2	98	4,25	16	8	441
3	106	2,50			285
4	126	2,75			346
	412		26	8	1359
	2587		51	8	Total on page 6282

17 Cabourne Owners Names

Hamilton Wm M
 Hamilton Wm
 do Benj M
 do Saml
 No. 13440, 13449 & 13526 C Wallace 614a (Niley) Abraham



Lot	Acres	Value	Plowland	Header	Remarks	Total Value
12	100	4,00				4,00
1	40	29,00				1,80
3	100	4,20	10			4,20
4	100	4,75	25			7,60
5	100	3,00				3,00
6	51	4,75	10		Sold to McKullen	2,42
7	75	4,75	22			350
8	50	4,50	10	10	From Saml Perkins	215
10	393	2,75	20	20		10,81
9	120	5,00	25		20 from W Hamilton	600
18	30	4,00	6		From Saml Perkins	1,120
13	150	8,00	60	20		1200
Total on page						5774

nos. 155 and the 50 in 3607 Mrs Pelham are into the calculation in making the aggregate. Definition of terms "separate parcel of real"

separated only to show at what price they enter. The Law makes it all a separate parcel of real property. See property, Sect 2nd. Hence an average price per acre to all.

Clabourne

Owners Names



N. 220
Massie Henry

N. 7009
McCollum Jas
Grindle Silvester
Robinson Tobias
Winegar John
Winegar Wm
Hagar C. H.
Heath Julius
Taylor Abraham
Warner John
Walters Martin
McBratney Saml

N. 6107 L. Jones - 633 1/2
Canal Land

G. Swan
N. 1-100a

N. 6107
Swan G.
Wells Jas. J.

S. T. Wells
N. 2-126a

Clabourne

4,16 2,00

1	125	2,50			312
2	50	3,00	0	0	150
3	100	4,00	20	10	424
4	117	3,80	22	2	445
5	117	3,80	25	2	445
6	50	2,00			100
7	50	2,00			100
8	75	3,50			282
9	80	3,50			280
10	79 1/10	3,50			280
11	2 1/10				95
		842	73	20	2893

1	100	3,75	30	10	375
2	120	2,00	6		252

226 36 10 627

1068 109 36 Total on page 3820

Claburne

Owners Names

No. 8807
 McGiffin Wm
 Leroy John
 Mulvane Jno. M.
 Mulvane Jankin
 Peters Adam

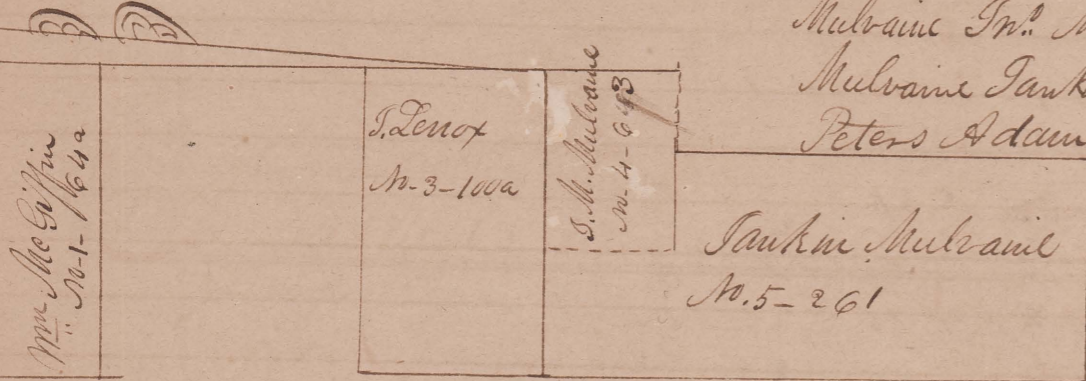

A. Peters
 No. 2-712a
 No. 8807 No. Pelham-1200a

No. 220 - V. Claburne. 12 50 ²/₃

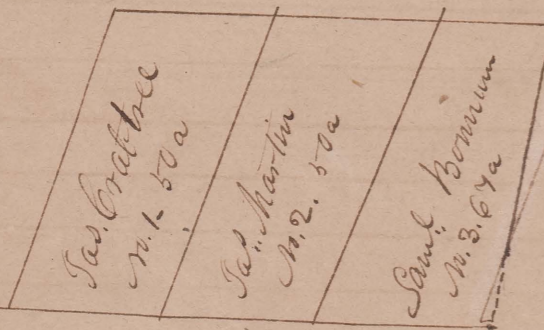

No. 220
 Olds Jos.
 Cratree Jas
 Martin Jas.
 Robison Tobias

Claburne

1	64	2,75		166
3	100	3,00		300
4	63	4,00	8	252
5	201	3,40	19	5887
2	712	2,75		1958
		1205	27	3568

	1069	2,00		Formerly 834 with Bonnum 2138
1	50	3,50	15	175
2	50	3,75	12	187
3	64	2,60		Sold to Saml. Bonnum 174
		1236	27	2674
		2436	54	Total on page 6237

Clairmont

No 5809 - John Nichols - 2000 a

Miller Road

Summerside Road

J. Mathew's valued at \$2,00 per acre.
2404a x 2,00 = \$4808,00

Owners Names

No 7008 -

Seacock Mrs J.

Seacock Mrs J.

Jackson Mrs

No 5809

Mathew Joshua

Wm & Isaac

No 7008

No 3 N 1 & 2

N 1

No 4

No 5

N 2

No 9

No 8

N 3

No 11

No 11

No 15

N 4

No 14

N 5

No 16

No 17

No 21

N 6

No 20

No 22

N 7

No 23

N 8

Lt	Acres	Value	plow	Meadow	Anything	Nothing	Total Value
136	150	2,50	8		Sold to Ben Fisher		675
	2280	2,50					5700
26	125	2,00			Plimmer's Road to Walls		1000
	2555						7375

Tanna road to Scots

2404 2,00

4808

4959

68 15 Total on page

12183

Ben Fisher

24000

No 2

N 9

N 9

No 5

N 2

No 8

N 3

No 11

No 14

N 4

N 5

No 17

No 20

No 24

Seacock

No 1-180

Sold to

Ben Fisher

M. J. Seacock

No 16

N 2

No 7

N 2

N 2

No 12

No 13

N 2

N 2

No 18

No 19

N 2

Mrs Jackson

No 25 No 26-125a

Seacock Seacock

Grwin road to Scots

Blanton Stall road

Marian Stall road

River road

No 5809 - John Nichols - 2000 a

Clairborne

Owners Names

DEPT
OF
AGRICULTURE

Clairborne

Summary of
So far as Cleared

Total A
Total Value
Average
Total Number
" "
" "

Clairborne
June 27th, 1846

acres in township	18 72 1/4
Total value	\$ 62 851
Value	\$ 2, 35 8536+
of acres of plow land	1248
" " meadow land	448
" " Cleared land	1696